

FIRENZE / PERETOLA

AD ELEV 142
APRON ELEV 125
TWR 118.300
122.100
ATIS 129.350

LIRQ

43°48'31" N

011°12'10" E

(*) 114 m beyond RWY END 05 AVBL for TAKE-OFF RWY 23
 (**) 45 m beyond RWY END 23 AVBL for TAKE-OFF RWY 05
 (***) RWY pavement surface is Prouse Friction Course (PFC) equivalent. The equivalence condition is based on mean texture depth (MTD) greater than 1.14mm and friction coefficient (MU) greater than 0.47.
 (****) RESA RWY 23 partially paved. Last 6 m variable width from 150 m to 90 m
 (*****) RESA RWY 05 partially paved. Last 23 m variable width from 150 m to 64 m

Bearing are magnetic
 Distances in metres
 Elevation in ft AMSL
 Coordinates WGS 84

RWY	QFU	THR	bearing strength
05	046°	N 43°48'21.49" E 011°11'55.65"	PCN 103/F/A/W/T
23	226°	N 43°48'40.31" E 011°12'24.73"	

TWY IDENT	WIDTH	bearing strength
F	22	PCN 48/F/A/W/T
G	15	PCN 57/F/B/W/T
H	18	PCN 58/F/A/W/T
L	17	PCN 120/F/A/W/T
M	21	PCN 116/F/A/W/T
K	18	PCN 78/F/A/W/T
P	17	PCN 78/F/A/W/T

APRON AREA

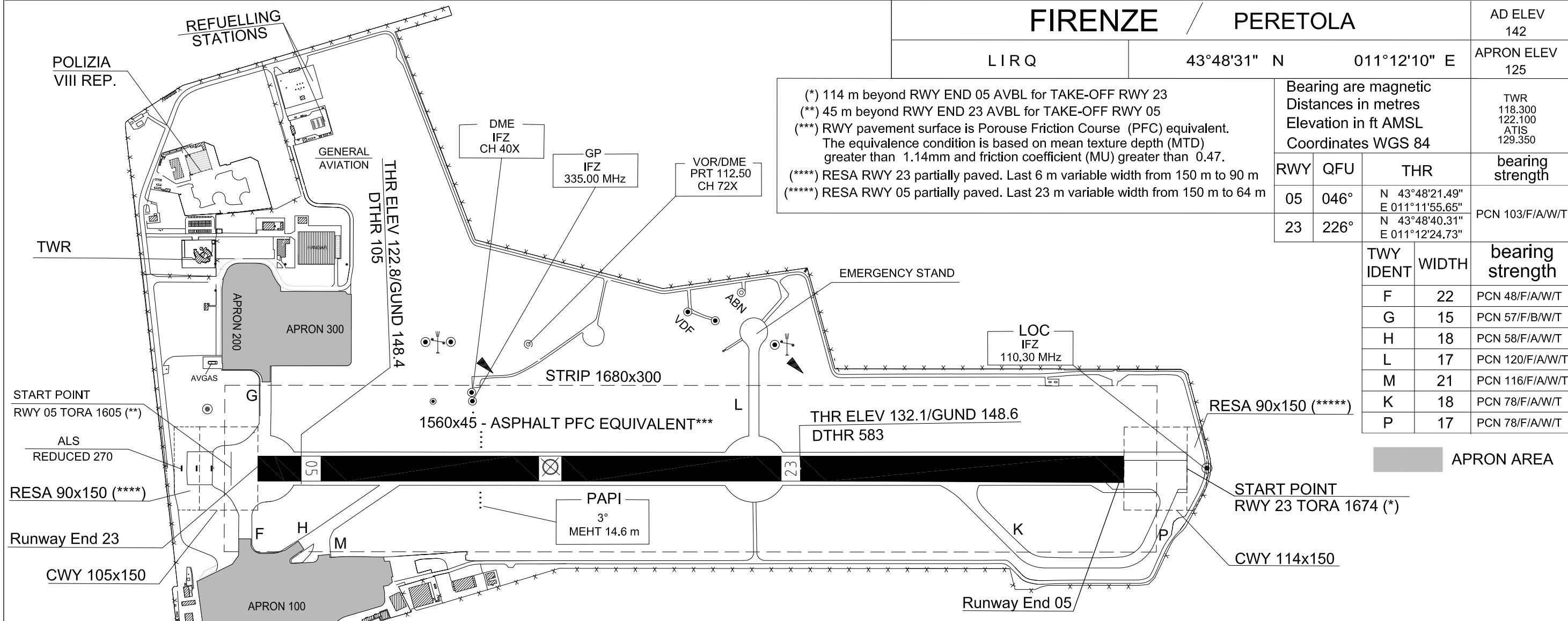

CHANGE: APRON LIMITS

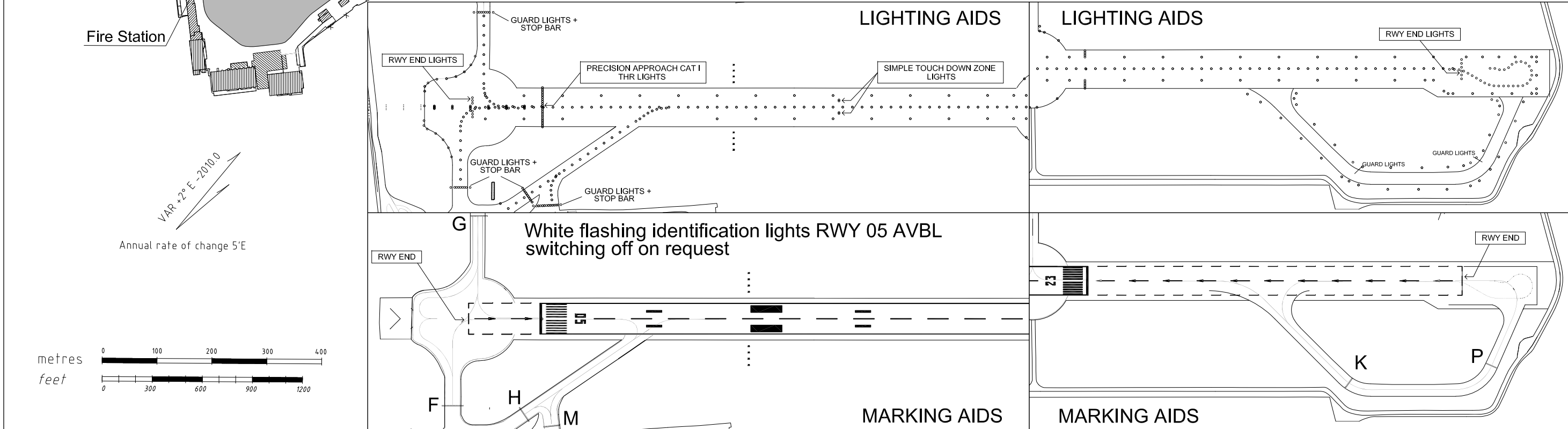

VAR +2° E - 2010.0
 Annual rate of change 5'E

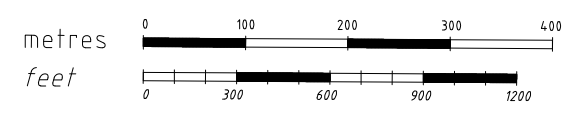

FIRENZE / PERETOLA		TWR 118.300 122.100 ATIS 129.350
LIRQ	43°48'31" N 011°12'10" E	

- HOT SPOTS, BE AWARE THAT:**
- Short taxi distance from ramp to hold position for runway
 - RHP F,G,H are far away from the runway
 - When leaving the runway from TWY F/H/M you are entering directly in the apron
 - Rwy 05 is used for arrivals and RWY 23 for departures
 - TWY H and M are oblique taxiways, entering in the runway limits the ability to scan final approach area RWY 05

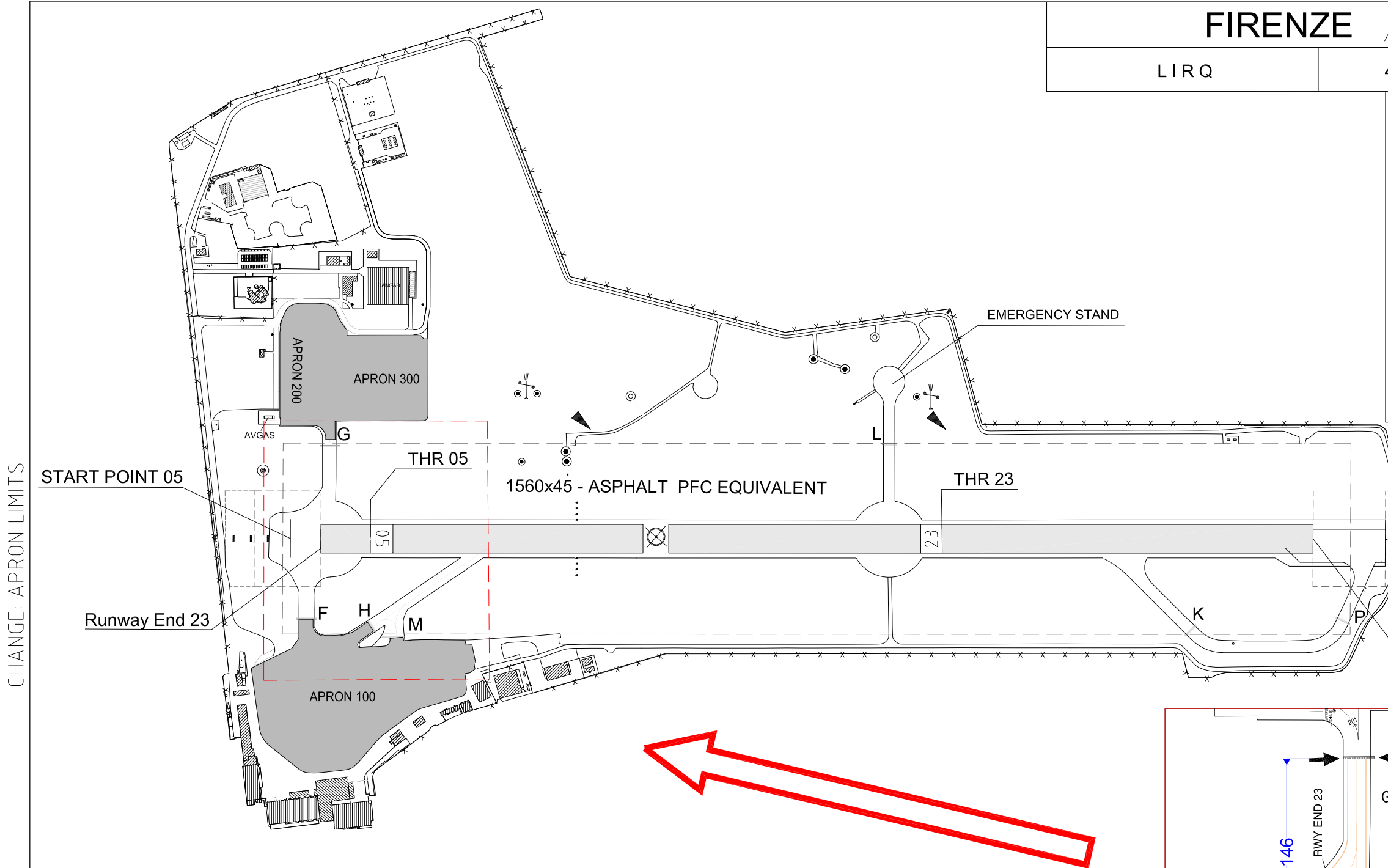

CHANGE: APRON LIMITS

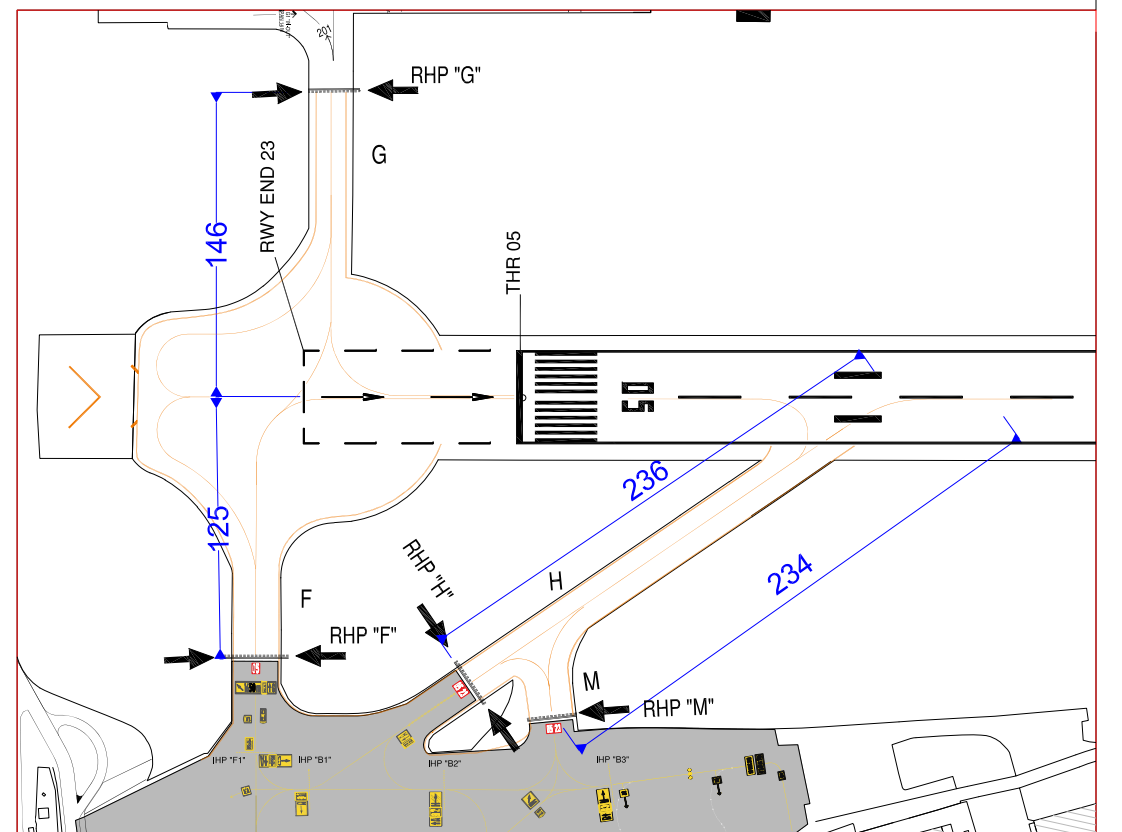

LEGEND	
	APRON AREA
	RHP RUNWAY HOLDING POSITION
	IHP INTERMEDIATE HOLDING POSITION

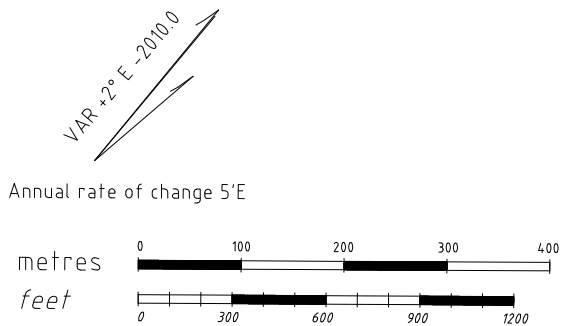

FIRENZE

PERETOLA

AD ELEV
142

LIRQ

43°48'31" N



011°12'10" E

APRON ELEV
125

Bearing are magnetic
Distances in metres
Elevation in ft AMSL
Coordinates WGS 84

TWR
118.300
122.100
ATIS
129.350

LEGEND

- LANDING AIRCRAFT ROUTING 
- TAKE-OFF ABORTED ROUTING 
- DEPARTING AIRCRAFT ROUTING 

APRON AREA 

ILS CRITICAL AREAS 

ILS SENSITIVE AREAS 

CHANGE: APRON LIMITS

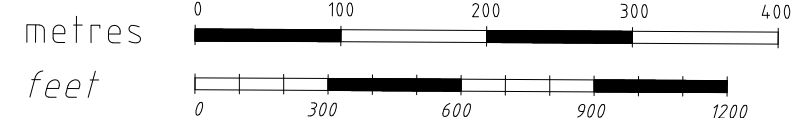
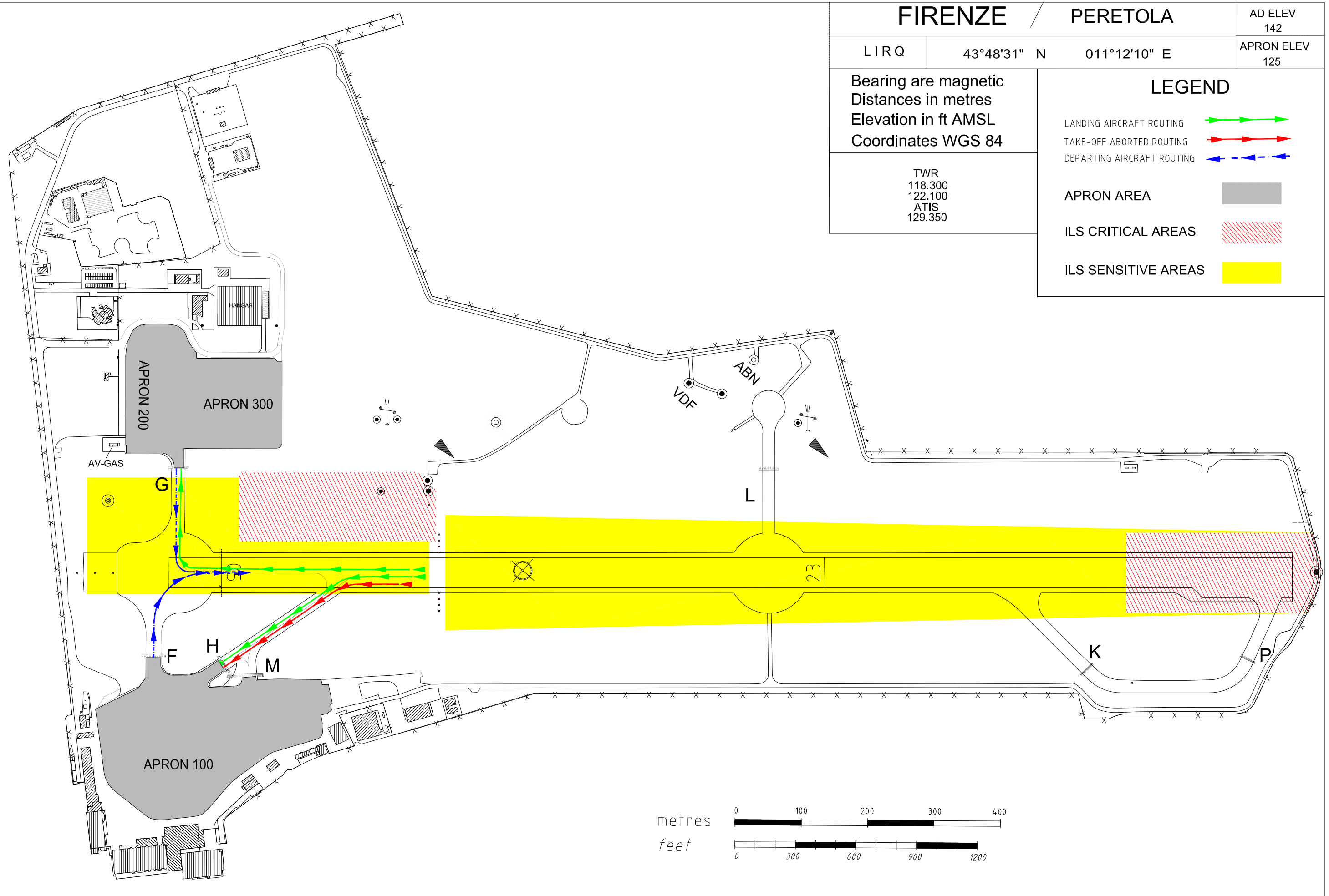

Bearing are magnetic Distances in metres Elevation in ft AMSL Coordinates WGS 84	TWR 118.300 122.100 ATIS 129.350	AD ELEV 142	LIRQ	FIRENZE / PERETOLA 43°48'31" N 011°12'10" E			
	APRON ELEV 125						

APRON			APRON 100			APRON 200			APRON 300			INTERMEDIATE POINT			
Lighting	Bearing strength		STANDS	N	E	STANDS	N	E	STANDS	N	E	F-1	N	E	
Edge: NIL	101 :	PCN 101/R/C/W/T	101	43°48'11.98"	011°11'55.66"	201	43°48'23.65"	011°11'43.79"	301	STOP 1	43°48'25.74"	011°11'48.74"	B-1	43°48'14.73"	011°11'57.87"
	102 :	PCN 72/R/C/W/T	102	43°48'10.13"	011°11'58.67"	202*	43°48'23.22"	011°11'44.72"	302	STOP 2	43°48'25.76"	011°11'48.87"	B-2	43°48'16.11"	011°12'00.02"
	103 :	PCN 95/R/C/W/T	103	43°48'10.35"	011°12'1.17"	203	43°48'25.01"	011°11'42.13"		STOP 1	43°48'28.24"	011°11'45.61"	B-3	43°48'17.91"	011°12'02.63"
	104 :	PCN 120/R/B/W/T	104	43°48'11.48"	011°12'3.41"	204*	43°48'24.09"	011°11'43.64"	303	STOP 2	43°48'28.33"	011°11'45.65"	E-1	43°48'26.71"	011°11'46.81"
	105 :	PCN 77/F/A/W/T	105	43°48'13.77"	011°12'4.09"	205*	43°48'24.96"	011°11'42.58"		STOP 1	43°48'26.79"	011°11'50.15"	EMERGENCY STAND		
	106 :	PCN 103/F/A/W/T	106	43°48'15.38"	011°12'4.39"	206	43°48'26.36"	011°11'40.46"	304	STOP 2	43°48'26.69"	011°11'50.09"	E - S	43°48'44.61"	011°12'13.94"
	107 :	PCN 120/F/A/W/T	107	43°48'16.74"	011°12'5.18"	207*	43°48'25.83"	011°11'41.50"		STOP 1	43°48'29.24"	011°11'47.17"			
	108 :	PCN 54/F/D/W/T	108	43°48'17.96"	011°12'6.28"	208*	43°48'26.70"	011°11'40.43"	STOP 2	43°48'29.22"	011°11'47.04"				
	201 - 208 :	PCN 47/F/B/W/T	TECHNICAL POSITION			TECHNICAL POSITION									
	301 - 304 :	PCN 120/F/A/W/T	N-1	43°48'18.62"	011°12'05.00"	N-3	43°48'22.73"	011°11'45.23"							
EMERGENCY STAND :	PCN 104/F/A/W/T	N-2	43°48'18.86"	011°12'05.78"	REMARK	* Stands alternative to 201, 203, 206									

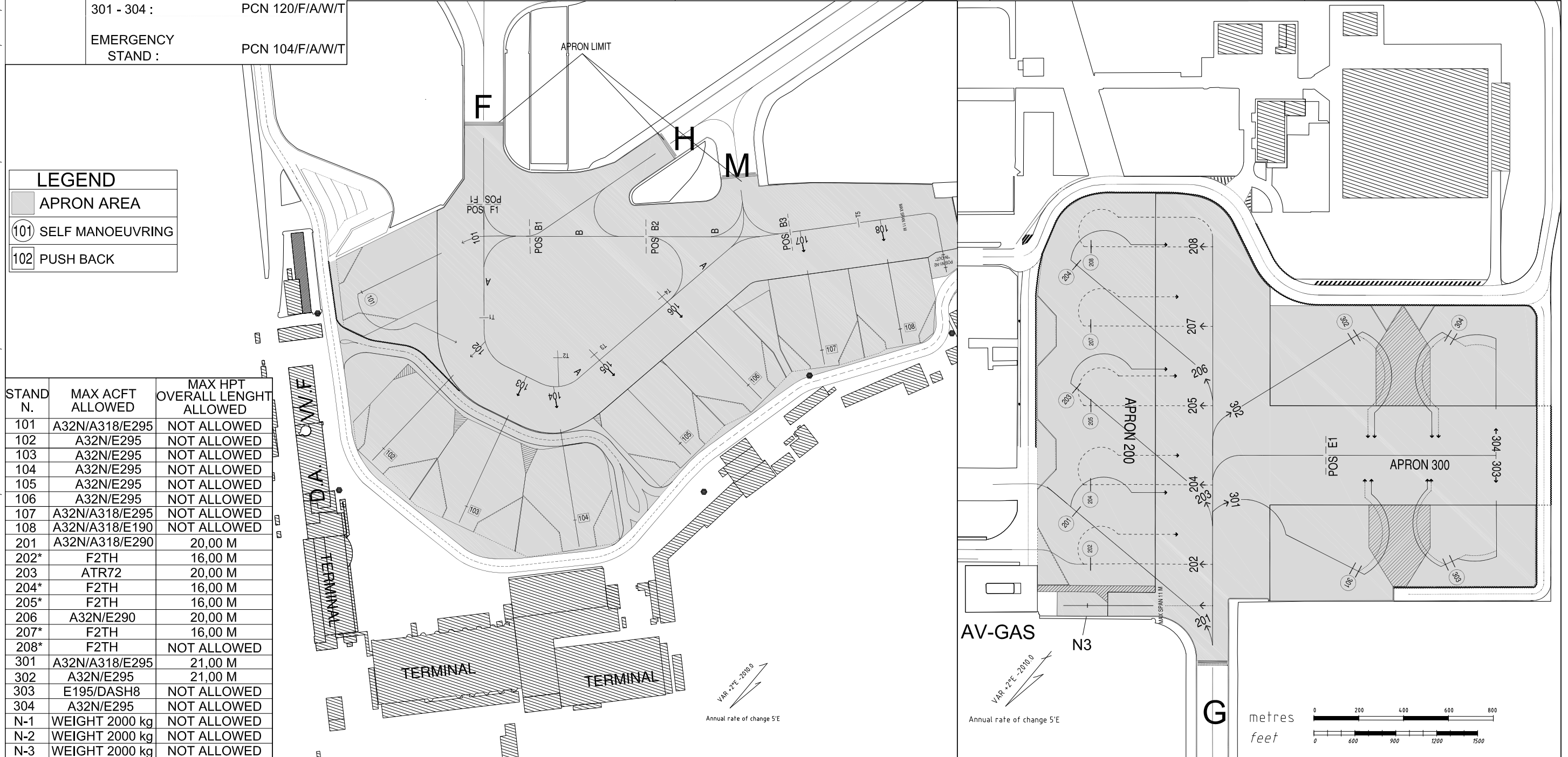

CHANGE : APRON LIMITS, NEW STAND 108, MAX ACFT ALLOWED, STANDS 305,306,307,308,309,310 WITHDRAWN

STAND N.	MAX ACFT ALLOWED	MAX HPT OVERALL LENGTH ALLOWED
101	A32N/A318/E295	NOT ALLOWED
102	A32N/E295	NOT ALLOWED
103	A32N/E295	NOT ALLOWED
104	A32N/E295	NOT ALLOWED
105	A32N/E295	NOT ALLOWED
106	A32N/E295	NOT ALLOWED
107	A32N/A318/E295	NOT ALLOWED
108	A32N/A318/E190	NOT ALLOWED
201	A32N/A318/E290	20,00 M
202*	F2TH	16,00 M
203	ATR72	20,00 M
204*	F2TH	16,00 M
205*	F2TH	16,00 M
206	A32N/E290	20,00 M
207*	F2TH	16,00 M
208*	F2TH	NOT ALLOWED
301	A32N/A318/E295	21,00 M
302	A32N/E295	21,00 M
303	E195/DASH8	NOT ALLOWED
304	A32N/E295	NOT ALLOWED
N-1	WEIGHT 2000 kg	NOT ALLOWED
N-2	WEIGHT 2000 kg	NOT ALLOWED
N-3	WEIGHT 2000 kg	NOT ALLOWED