

Bearings are magnetic Distances in metres Elevations in feet AMSL Coordinates WGS84		TWR 118.650 GND 121.755 ATIS 124.130	
RWY	QFU	THR	BEARING STRENGTH
04	043°	45° 23' 15.66" N 010° 52' 36.72" E	PCN 87/F/A/W/T
22	223°	45° 24' 14.46" N 010° 54' 02.25" E	PCN 87/F/A/W/T

AD ELEV 240	VERONA / VILAFRANCA	
APRON ELEV 232	LIPX	45° 23' 47" N 010° 53' 16" E

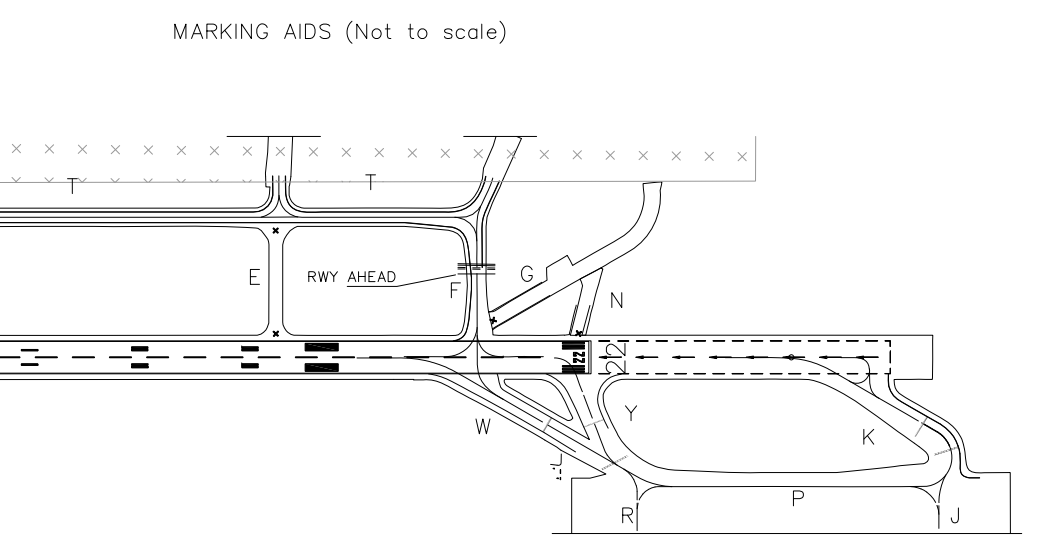
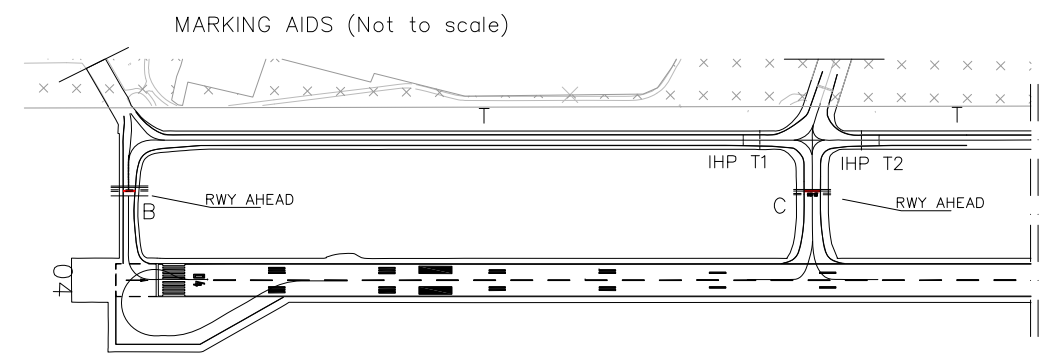
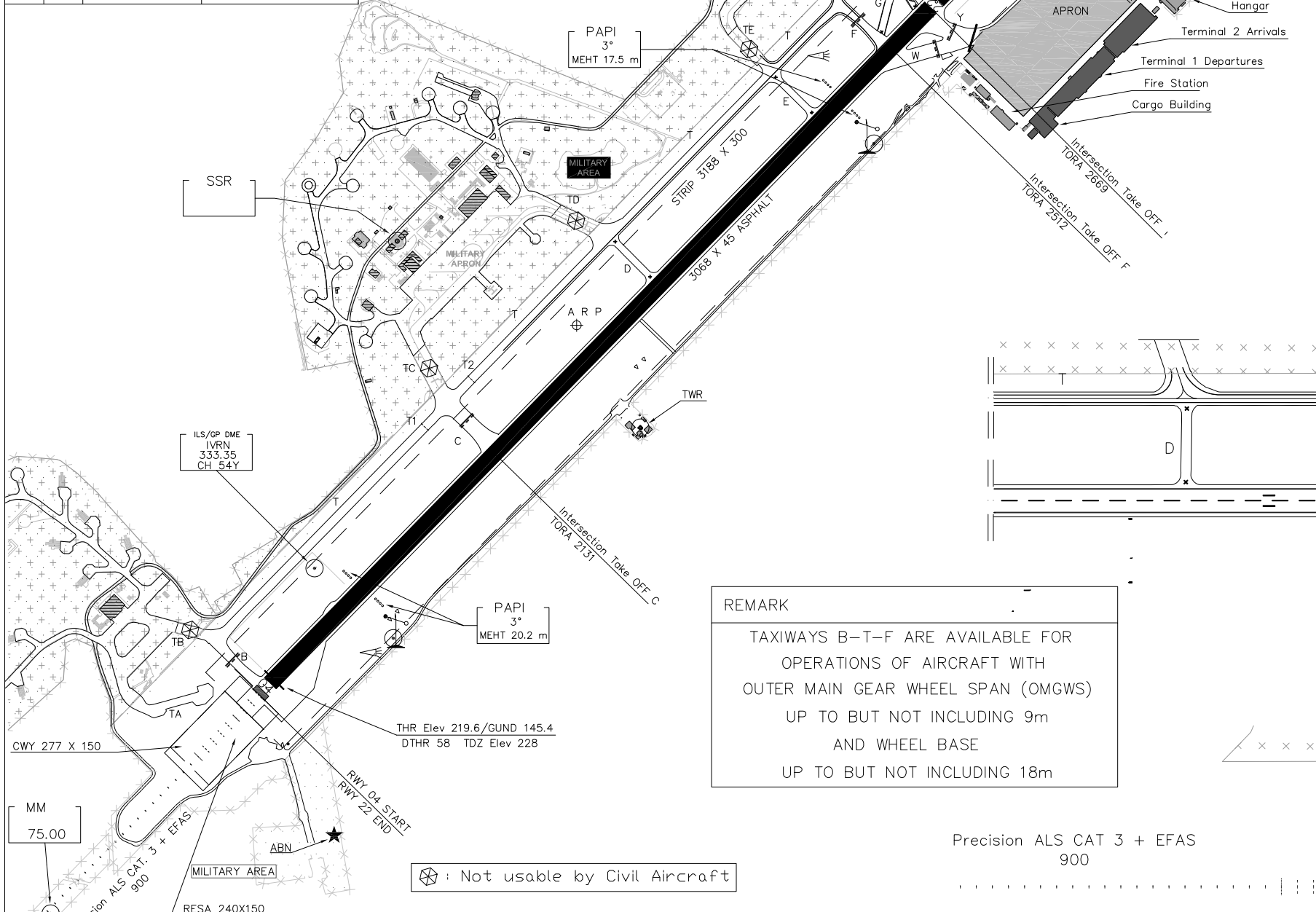

REMARK
 TAXIWAYS B-T-F ARE AVAILABLE FOR OPERATIONS OF AIRCRAFT WITH OUTER MAIN GEAR WHEEL SPAN (OMGWS) UP TO BUT NOT INCLUDING 9m AND WHEEL BASE UP TO BUT NOT INCLUDING 18m

Precision ALS CAT 3 + EFAS
 900

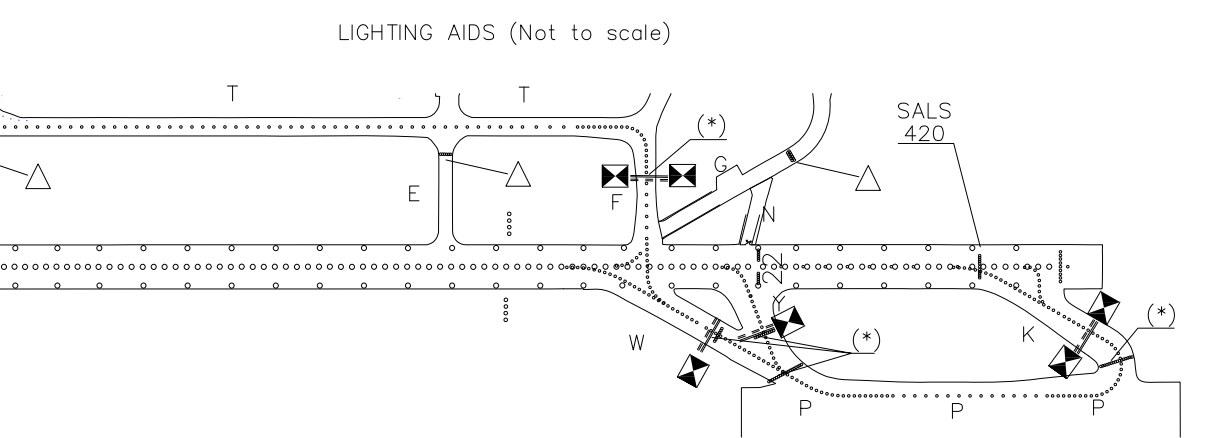
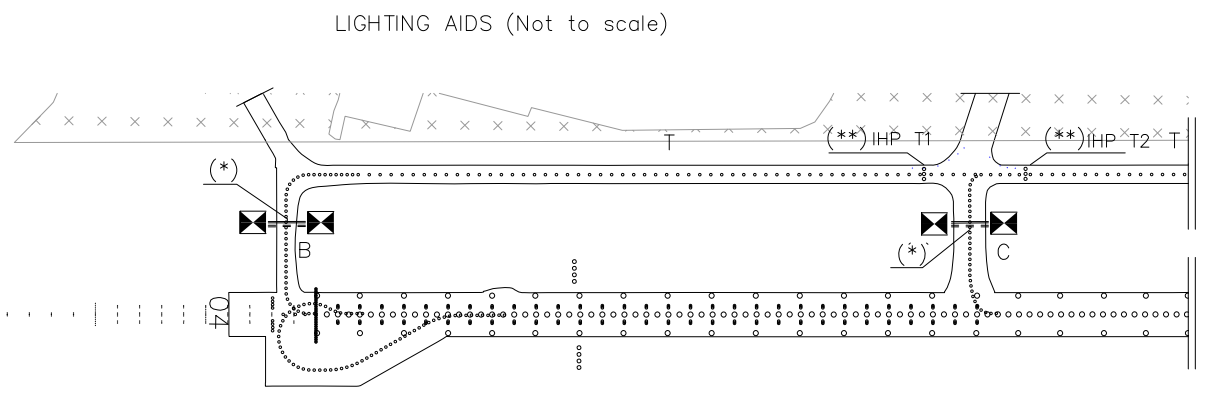

IDENT	WIDTH	SURFACE	BEARING STRENGTH
B	15	Asphalt	PCN73/F/A/W/T
C	23	Asphalt	PCN120/F/A/W/T
D	NIL	Asphalt	NIL
E	NIL	Asphalt	NIL
F	15	Asphalt	PCN73/F/A/W/T
G	NIL	Asphalt Concrete	NIL
K	28	Asphalt	PCN70/F/A/W/T
N	NIL	Asphalt Concrete	NIL
T	15	Asphalt	PCN73/F/A/W/T
W	23	Asphalt	PCN67/F/A/W/T
Y	30	Asphalt	PCN100/F/A/W/T

- MILITARY AREA
- (*) STOP BAR
- (**) IHP
- △ RED FIXED LIGHT

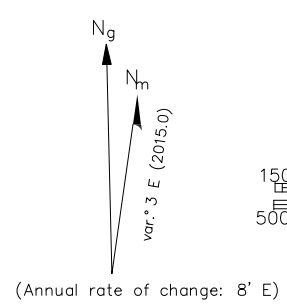

⊗ : Not usable by Civil Aircraft

CHANGE: GND AND ATIS FREQUENCY MODIFIED AND UPDATED CHART

ATC SERVICES	
TWR	118.650
GND	121.755
ATIS	124.130

AD ELEV	240	VERONA / VILLAFRANCA	
APRON ELEV	232	L I P X	45°23' 47"N 010° 53' 16"E

HOT SPOT	DESCRIPTION
HS1	APRON AND MAIN PORTION OF TAXIWAYS FROM APRON TO HOLDING POINTS RWY22 NOT VISIBLE FROM TWR
HS2	BE AWARE OF THE COMPLEX LAYOUT DO NOT VACATE ON "Y"
HS3	NO TAXI ALLOWED BETWEEN T1 AND T2 WHEN AN ACFT IS HOLDING AT RHP CHARLIE. FOLLOW CAREFULLY ATC INSTRUCTIONS.

CHANGE: GND AND ATIS FREQUENCY MODIFIED AND UPDATED CHART

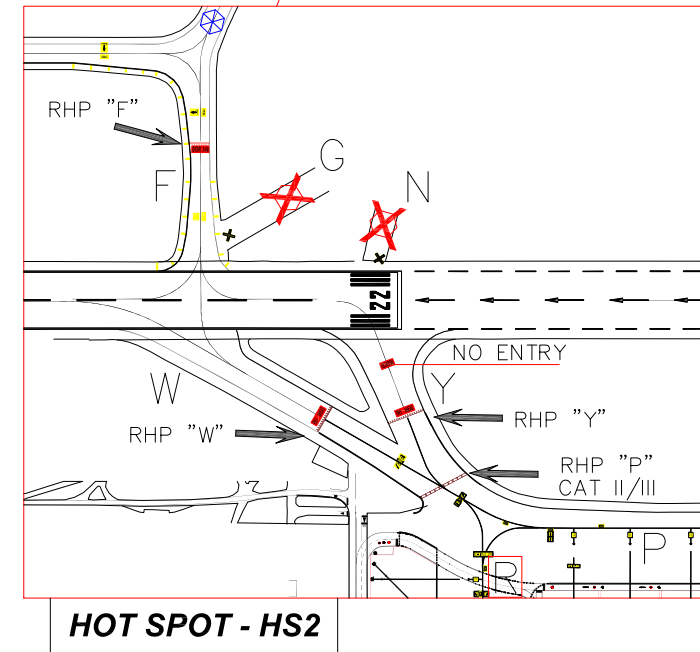
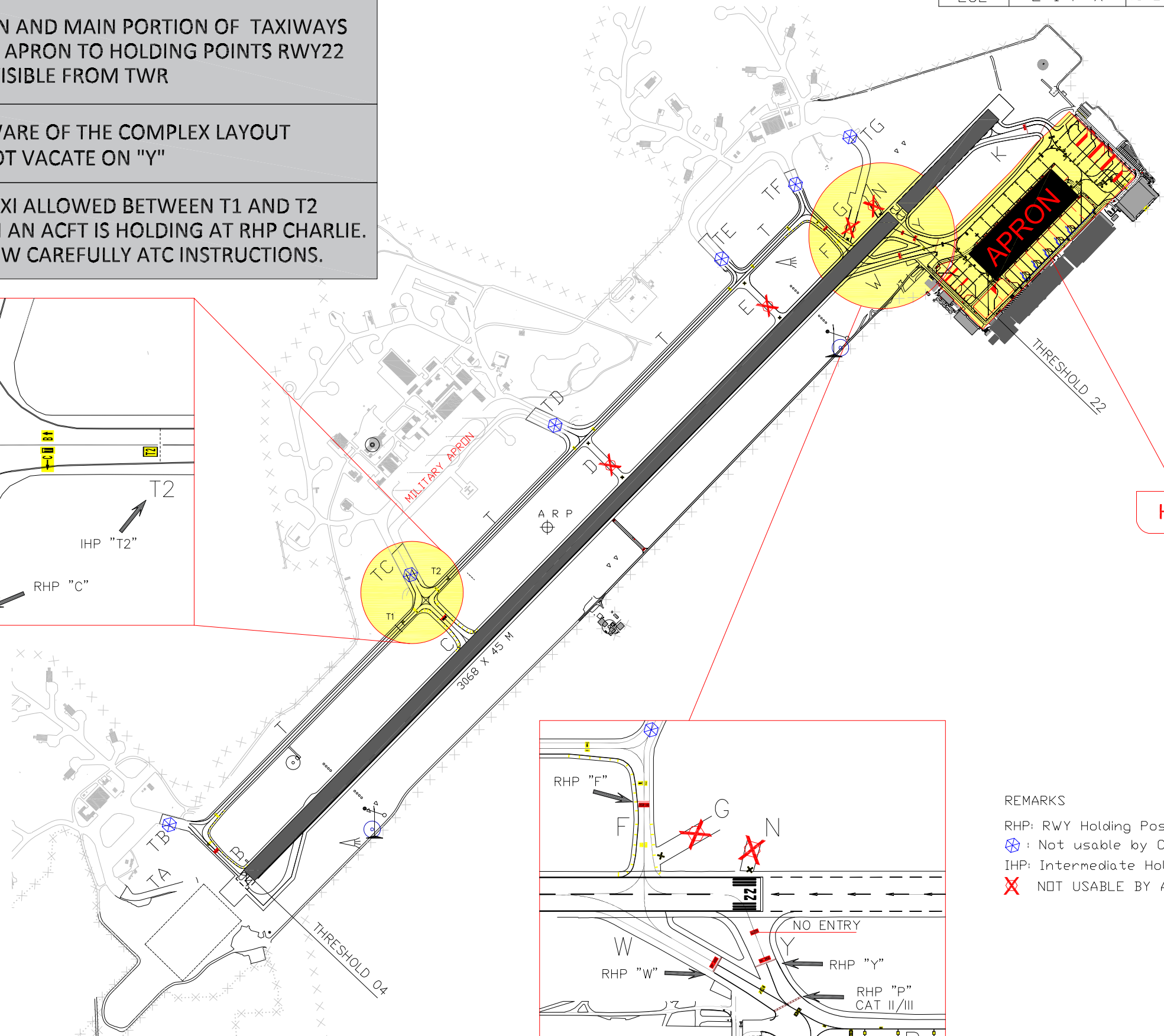
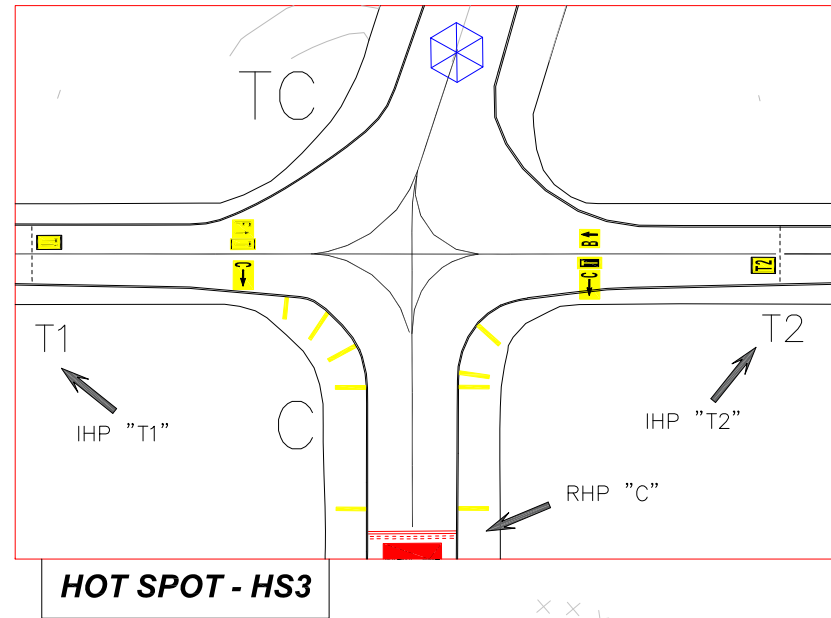

HS1

- REMARKS
- RHP: RWY Holding Position
 - ⊗: Not usable by Civil Aircraft
 - IHP: Intermediate Holding Position
 - ✗: NOT USABLE BY ACFT

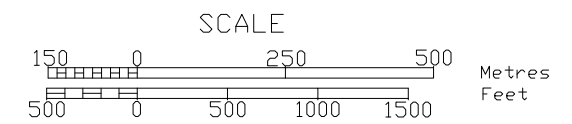
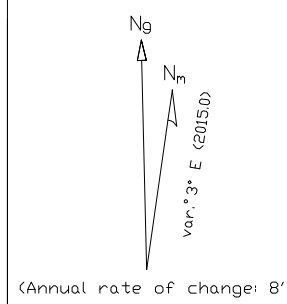

ATC SERVICES		
TWR 118.650	GND 121.755	ATIS 124.130

WARNING: DIFFERENT ROUTINGS COULD BE AUTHORIZED AT ATC DISCRETION

AD ELEV 240	VERONA / VILLAFRANCA	
APRON ELEV 232	L I P X	45° 23' 47"N 010° 53' 16"E

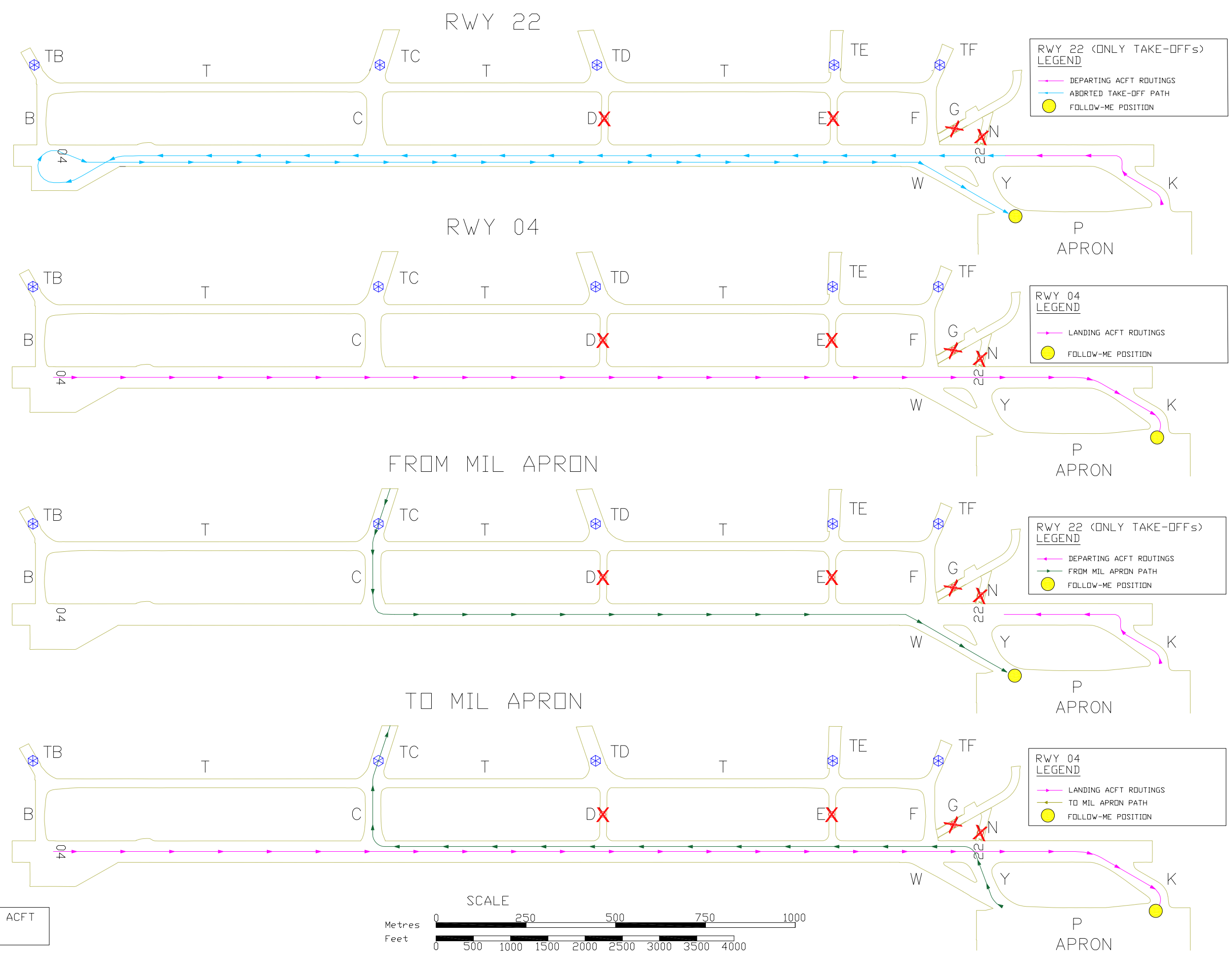
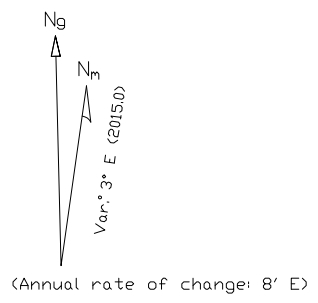

CHANGE: GND AND ATIS FREQUENCY MODIFIED AND UPDATED CHART

⊗ NOT USABLE BY CIVIL ACFT
 ✗ NOT USABLE BY ACFT

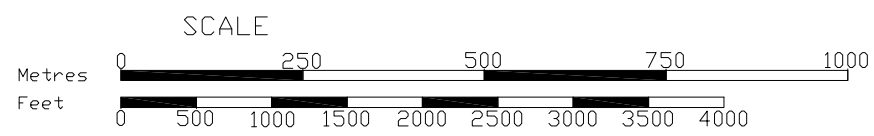

Bearings are magnetic
 Distances in metres
 Elevation in ft AMSL
 Coordinates WGS84

TWR 118.650
 GND 121.755
 ATIS 124.130

AD ELEV 240
 APRON ELEV 232

VERONA / VILLAFRANCA

L I P X 45°23'47" N 010°53'16" E

APRON

Lighting Bearing strength
 PCN 110/R/B/W/T

POINTS ON PARKING AREA

STANDS	N	E
11	45°24'09.17"	010°54'08.79"
12	45°24'09.30"	010°54'08.81"
13	45°24'08.35"	010°54'10.06"
14	45°24'07.41"	010°54'11.37"
21	45°24'06.07"	010°54'14.62"
22	45°24'06.28"	010°54'15.43"
23	45°24'07.32"	010°54'17.02"
31	45°24'11.36"	010°54'15.29"
32	45°24'12.34"	010°54'16.72"
33	45°24'13.40"	010°54'18.26"
34	45°24'14.47"	010°54'19.81"
35	45°24'15.53"	010°54'21.35"
36	45°24'16.59"	010°54'22.90"
37	45°24'17.65"	010°54'24.44"
41	45°24'08.54"	010°54'18.87"
42	45°24'09.50"	010°54'20.27"
43	45°24'10.54"	010°54'21.79"
44	45°24'11.59"	010°54'23.31"
45	45°24'12.64"	010°54'24.83"
46	45°24'13.68"	010°54'26.35"
47	45°24'14.73"	010°54'27.87"
48	45°24'13.86"	010°54'27.07"

REMARKS

- 1 - FOR ALL STANDS ENTRY WITH MARSHALLING ASSISTANCE MANDATORY
- 2 - STAND 11-31-41-51 AVAILABLE FOR ACFT WITH MAX WINGSPAN LESS THAN 29M
- 3 - AIRCRAFT STAND TAXILANE R AVAILABLE FOR ACFT WITH MAX WINGSPAN 52M
- 4 - AIRCRAFT STAND TAXILANE J AVAILABLE FOR ACFT WITH MAX WINGSPAN 65M
- 5 - AIRCRAFT STAND TAXILANE M AVAILABLE FOR ACFT WITH MAX WINGSPAN 36M

POINTS ON PARKING AREA

STANDS	N	E
511	45°24'23.01"	010°54'26.71"
512	45°24'22.27"	010°54'27.73"
51	45°24'22.57"	010°54'26.96"
52	45°24'21.26"	010°54'28.95"
53	45°24'21.99"	010°54'28.62"
54	45°24'20.13"	010°54'30.52"
55	45°24'20.40"	010°54'30.85"
56	45°24'19.01"	010°54'32.08"
57	45°24'18.09"	010°54'33.53"

APN TWY M R J
 IN ORDER TO AVOID JET BLAST HAZARDS PILOTS ARE REQUESTED TO MANAGE AIRCRAFT AT MINIMUM THRUST

LEGEND

- APRON AREA
- 31 SELF MANOEUVRING EXIT
- PUSH-BACK EXIT
- 51 SELF MANOEUVRING OR PUSH-BACK EXIT

CHANGE: GND AND ATIS FREQUENCY MODIFIED AND UPDATED CHART

