

Bearings are magnetic  
Distances in metres  
Elevations in feet AMSL  
Coordinates WGS84

TWR  
131.225

RWY	QFU	THR	BEARING	STRENGTH
13	126°	44°01'36.49"N 012°36'00.23"E	PCN 79/F/A/W/T	
31	306°	44°00'49.43"N 012°37'24.61"E	PCN 79/F/A/W/T	

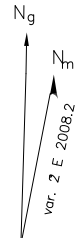

(Annual rate of change: 5' E)

REMARKS
(1) TWY B must be used only as exit
(2) TWY H must be used only as EXIT by MIL ACFT
(3) TWY G closed
(4)(*) CAT I Runway Holding Position
(5)(**) Intermediate Holding Position
(6) ⊗ Not lighted and not usable by Civil ACFT
(7) ☒ Runway Guard Lights
(8) ⊞ NO ENTRY Signs
(9) ✕ TWY Closed

AD ELEV 41	RIMINI/Miramare		
APRON ELEV 28	LIPR	44°01'10"N	012°36'34"E

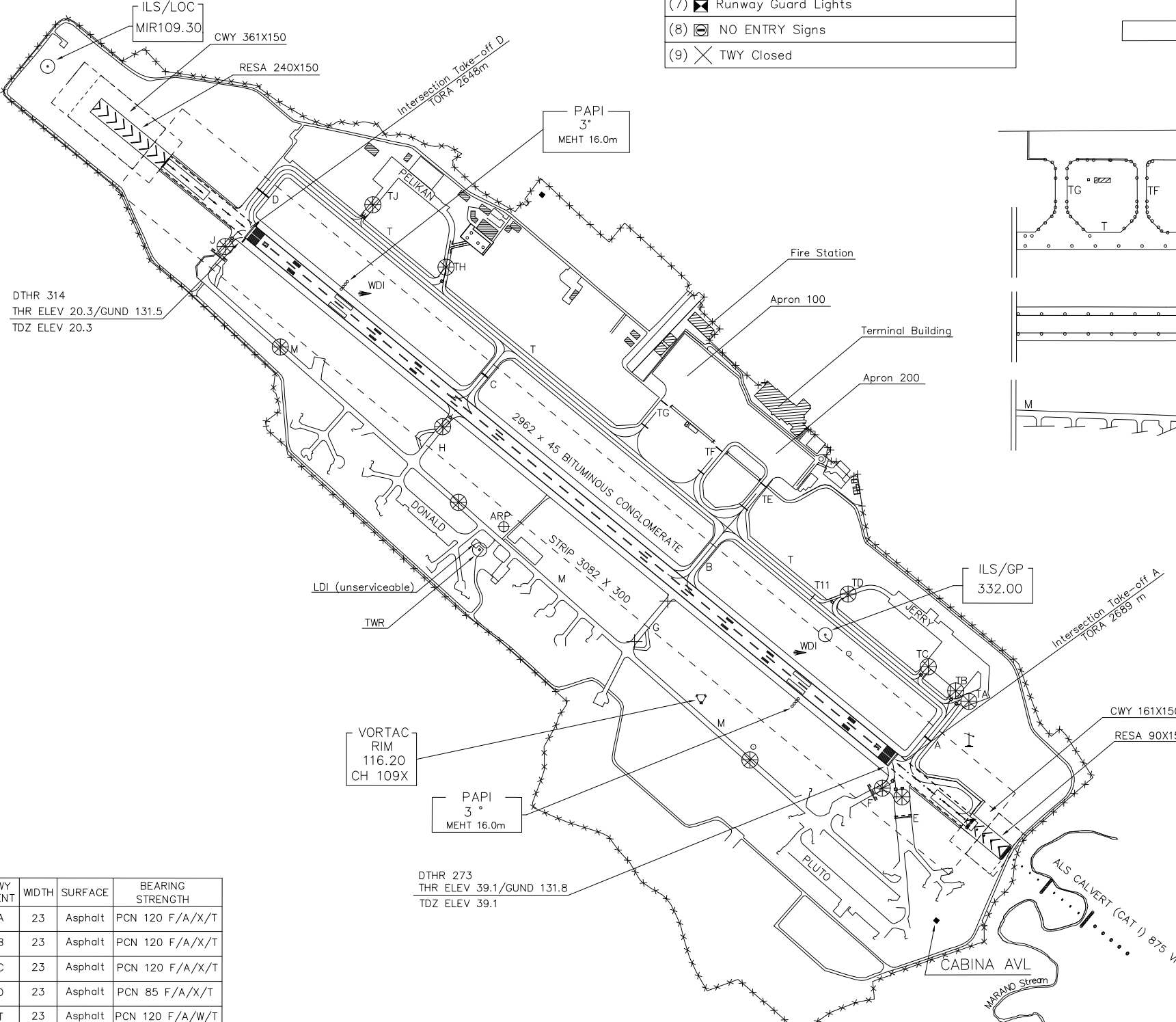

DTHR 314  
THR ELEV 20.3/GUND 131.5  
TDZ ELEV 20.3

DTHR 273  
THR ELEV 39.1/GUND 131.8  
TDZ ELEV 39.1

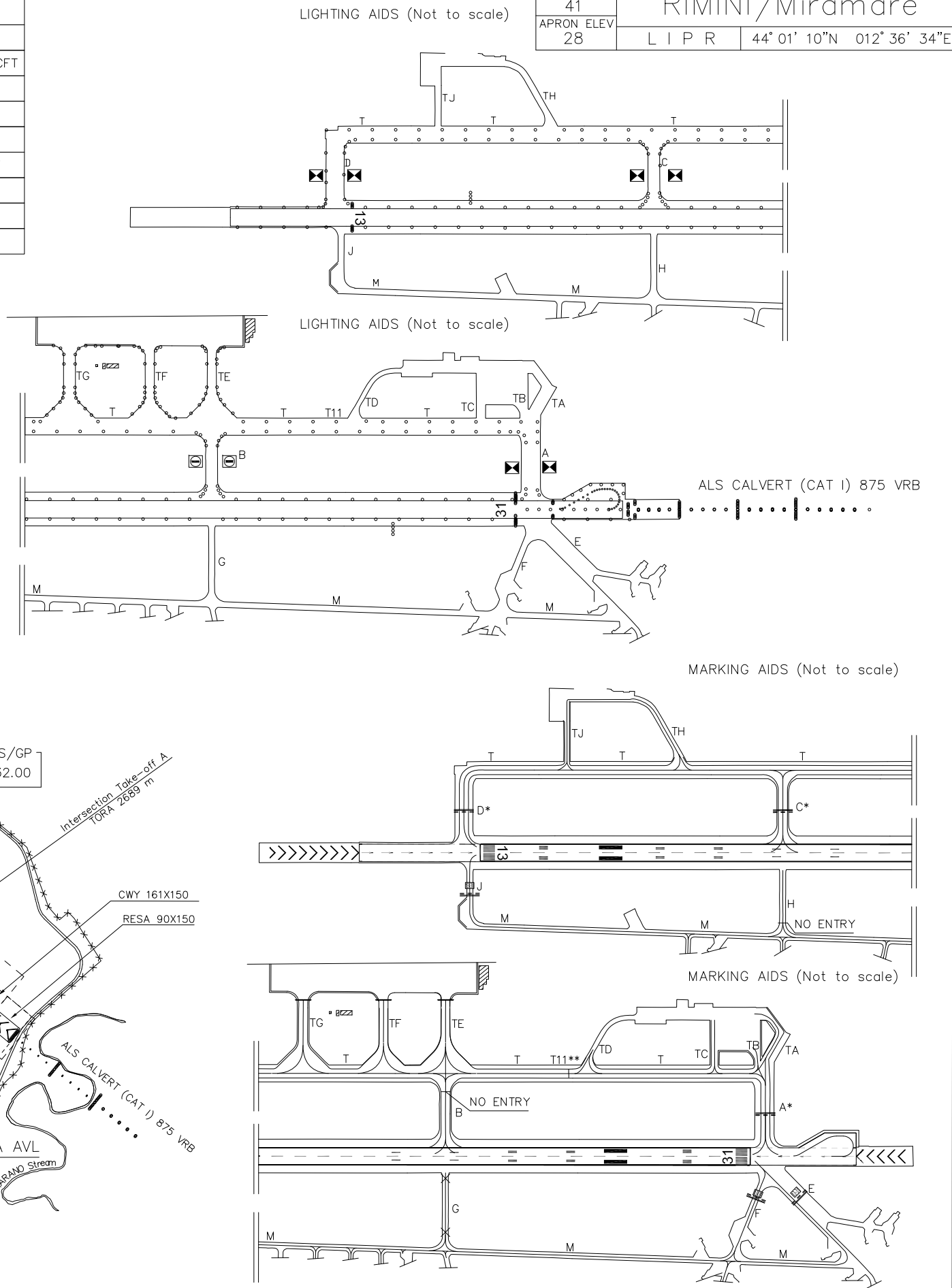
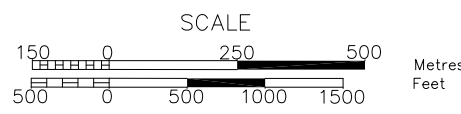

TWY IDENT	WIDTH	SURFACE	BEARING	STRENGTH
A	23	Asphalt	PCN 120 F/A/X/T	
B	23	Asphalt	PCN 120 F/A/X/T	
C	23	Asphalt	PCN 120 F/A/X/T	
D	23	Asphalt	PCN 85 F/A/X/T	
T	23	Asphalt	PCN 120 F/A/W/T	
TE	18	Asphalt	PCN 120 F/B/X/T	
TF	23	Asphalt	PCN 67 F/B/X/T	
TG	23	Concrete	PCN 74 R/C/X/T	

CHANGE: RESA RWY 13 and 31 dimensions and updated chart

Bearings are magnetic Distances in metres Elevations in feet AMSL Coordinates WGS84			TWR 131.225
RWY	QFU	THR	BEARING STRENGTH
13	126°	44° 01' 36.49"N 012° 36' 00.23"E	PCN 79/F/A/W/T
31	306°	44° 00' 49.43"N 012° 37' 24.61"E	PCN 79/F/A/W/T

AD ELEV 41	RIMINI/Miramare		
APRON ELEV 28	L I P R	44° 01' 10"N	012° 36' 34"E

REMARKS
(1) TWY B must be used only as EXIT
(2) TWY H must be used only as exit by MIL ACFT
(3) TWY G closed
(4)(*) CAT I Runway Holding Position
(5)(**) Intermediate Holding Position
(6)  Not lighted and not usable by Civil ACFT
(7)  Runway Guard Lights
(8)  NO ENTRY Signs
(9)  TWY Closed

CHANGE: RESA RWY 13 and 31 dimensions and updated chart

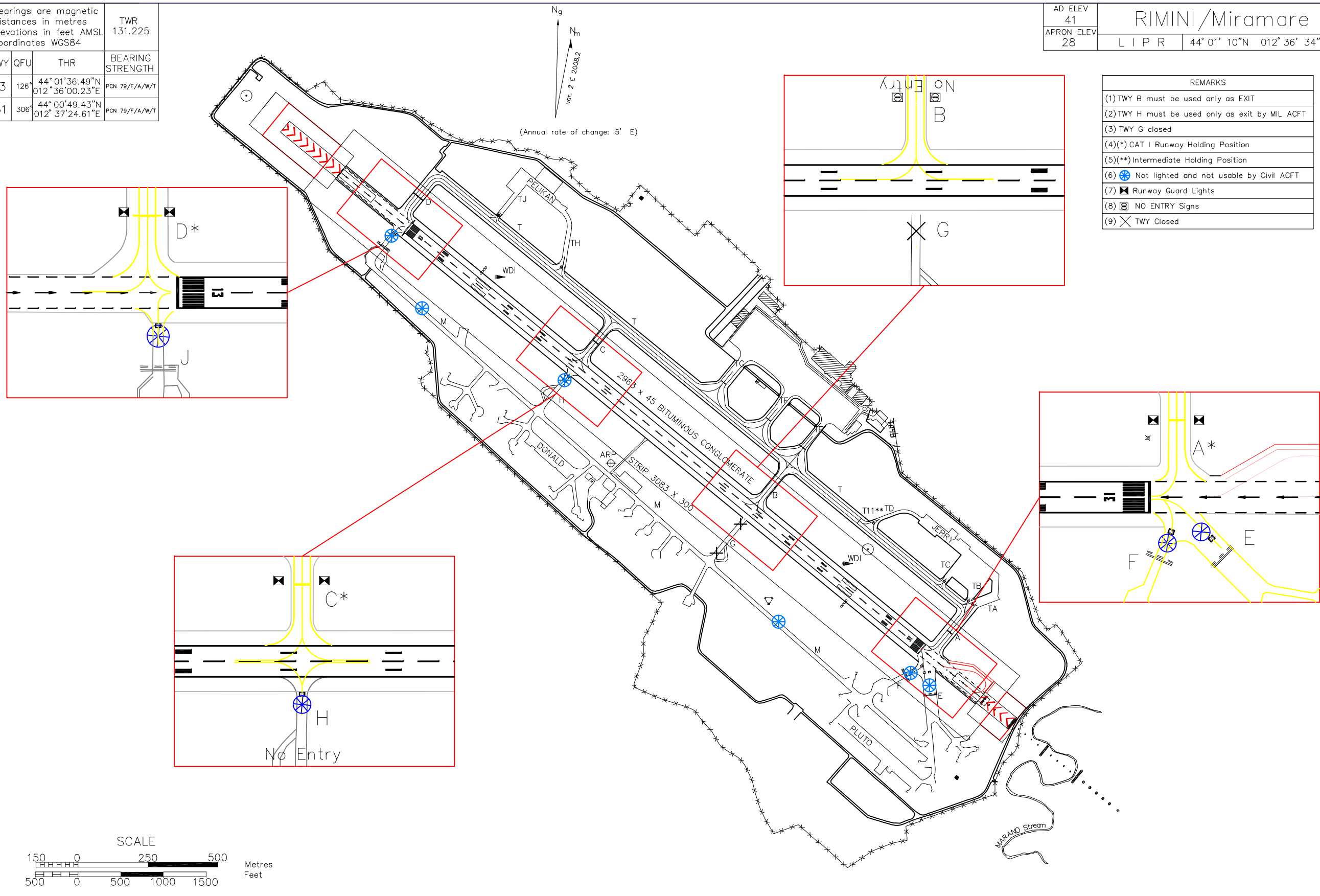

Bearings are magnetic Distances in metres Elevations in feet AMSL Coordinates WGS84		TWR 131.225
APRON		
LIGHTING	BEARING STRENGTH	
edge:blue	Surface: mq 29715 - concrete Strength: LCN 100	

AD ELEV 41	RIMINI/Miramare	
APRON ELEV 28	LIPR	44° 01' 10"N 012° 36' 34"E
POINTS ON PARKING AREA		
STANDS	N	E
101	44°01'24.93"	12°36'53.45"
102	44°01'26.03"	12°36'54.92"
103	44°01'25.09"	12°36'57.62"
104	44°01'26.74"	12°36'55.69"
105	44°01'25.90"	12°36'59.17"
106	44°01'27.45"	12°36'56.45"
201	44°01'26.93"	12°36'56.27"
202	44°01'25.67"	12°36'59.83"
203	44°01'23.22"	12°37'01.50"
204A	44°01'24.19"	12°37'02.59"
204B	44°01'23.88"	12°37'02.26"
205A	44°01'22.25"	12°37'03.91"
205B	44°01'22.08"	12°37'03.72"
206A	44°01'21.20"	12°37'05.28"
206B	44°01'21.02"	12°37'05.09"
207A	44°01'20.12"	12°37'06.87"
207B	44°01'19.99"	12°37'06.73"
208A	44°01'19.06"	12°37'08.75"
208B	44°01'18.93"	12°37'08.61"
209	44°01'17.23"	12°37'11.06"
210	44°01'17.97"	12°37'10.69"
211	44°01'17.00"	12°37'12.41"

VAR 2° E - 2008.2  
Annual rate of change 5'E

CHANGE: UPDATED CHART

**CAA'S Provisions:**

TWY "TE": max span 41 m  
TWY "TF": max span 41 m  
TWY "TG": max span 65 m

"Z": max span 65 m (stands 201-205)  
max span 41 m (stands 206-211)  
max span 12 m (T2- Aeroclub)

AHP "T1" :switch off engines for  
general aviation

START POINT "T2": Aeroclub

