

Bearings are magnetic		TWR 130.205	TWY IDENT	WIDTH	bearing strength
Distances in metres			A	23	PCN113/F/A/W/T
Elevation in ft AMSL			B	23	PCN120/F/A/W/T
Coordinates WGS 84			C	23	PCN120/F/A/W/T
RWY	QFU	THR	bearing strength		
09	088°	N45°49'40.63" E013°26'59.73"	PCN120/F/A/W/T	D	23
27	268°	N45°49'39.95" E013°29'09.49"	PCN120/F/A/W/T	E	23
				F	23
				G	10
				S	30

AD ELEV 40	TRIESTE / RONCHI DEI LEGIONARI	
APRON ELEV 30	L I P Q	45°49'39"N 013°28'20"E

CHANGE: bearing strength - lighting aids - IHP

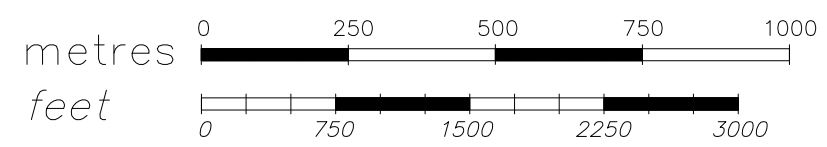
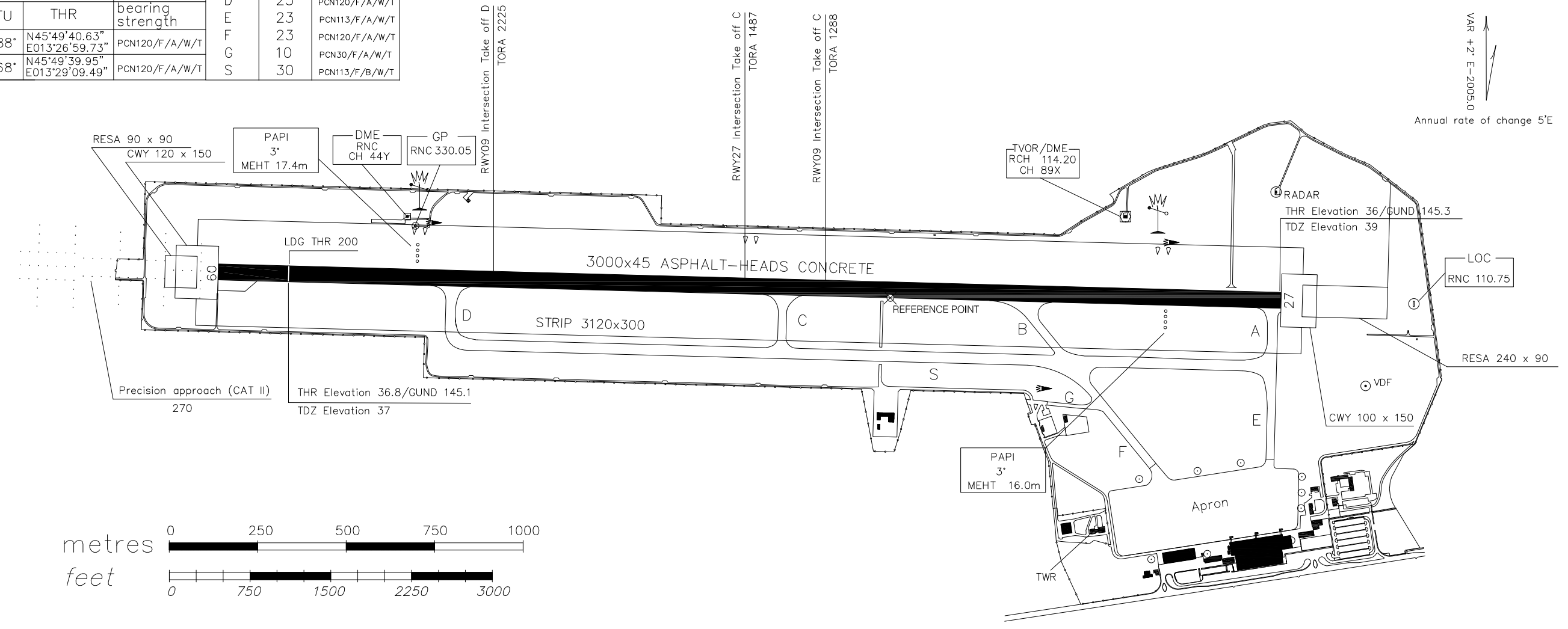

VAR +2° E -2005,0  
Annual rate of change 5'E

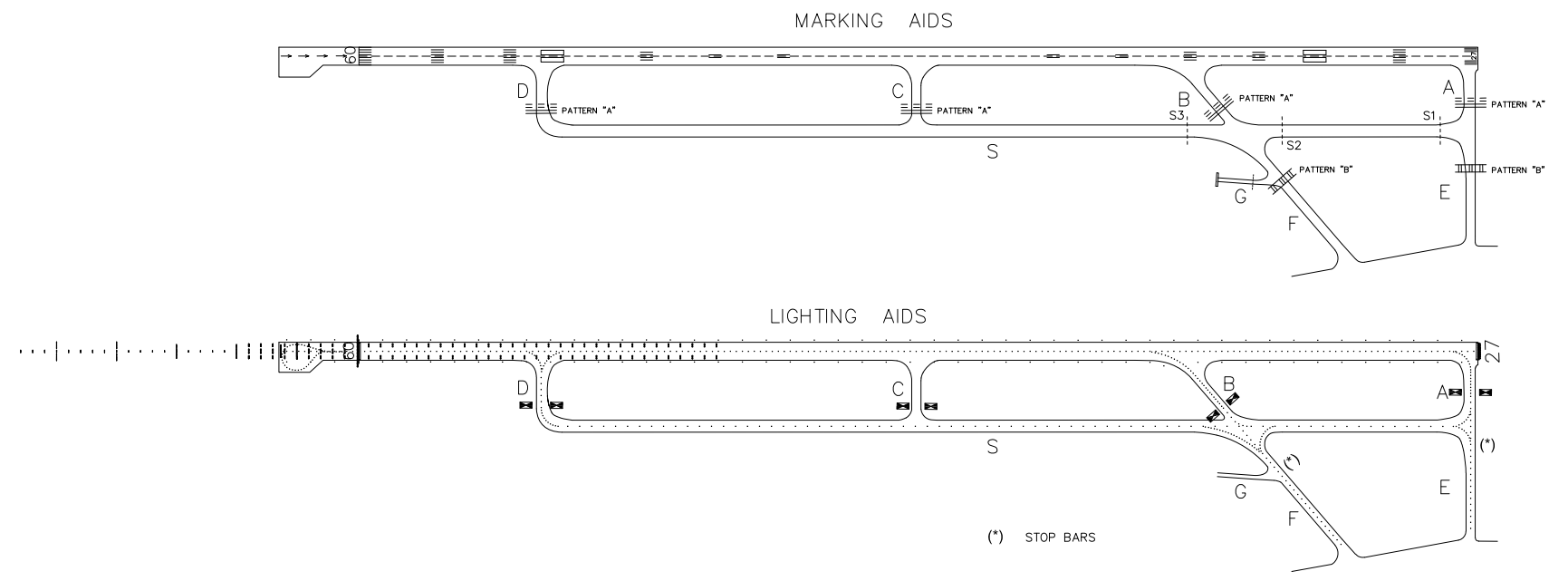
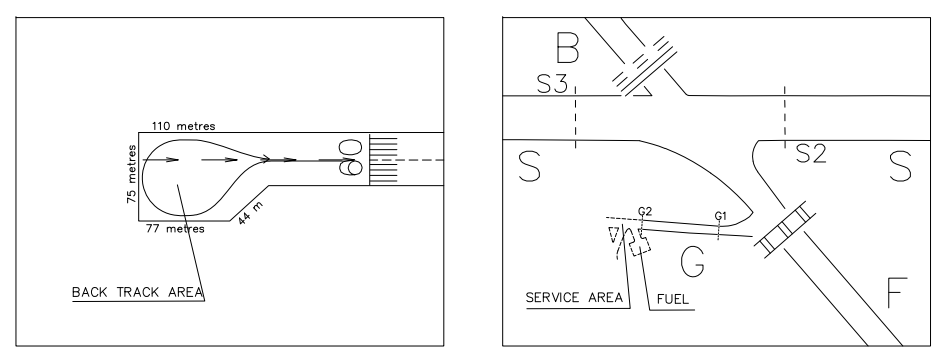

Bearings are magnetic Distances in metres Elevation in ft AMSL Coordinates WGS 84	TWR 130.205	AD ELEV 40	TRIESTE / RONCHI DEI LEGIONARI	
		APRON ELEV 30	L I P Q	45°49'39" N 013°28'20" E

APRON	
Lighting	Bearing strength
Edge: BLUE	Concrete Apron Taxilane: PCN 55 Bituminous conglomerate Apron Taxilane: PCN 120

REMARKS: SEE AD 2 LIPQ 2-5

- Area APRON
- CLS (concrete)
- Follow-me position

VAR +2° E - 2005.0

Annual rate of change 5'E

CHANGE: TWR FREQ updated

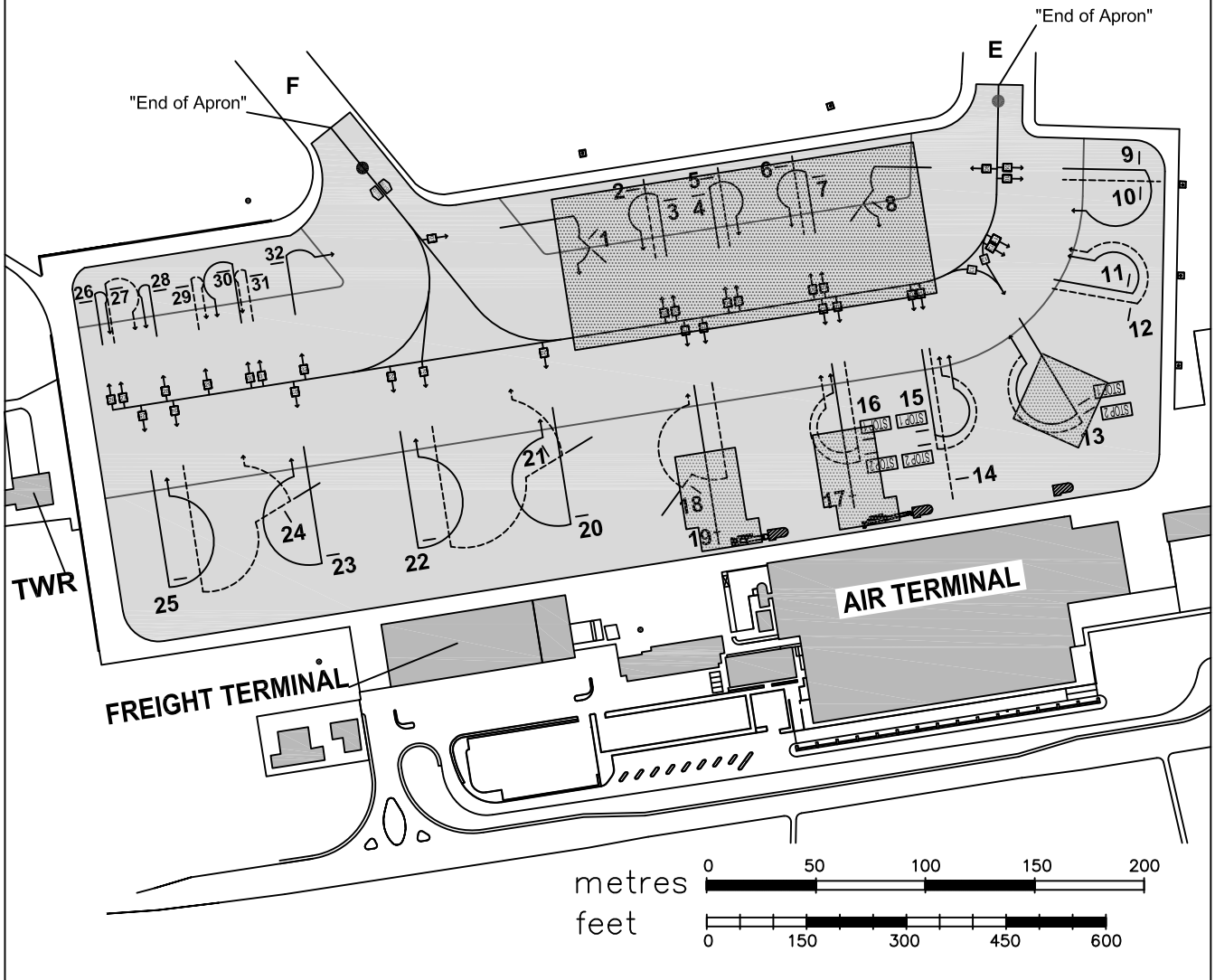

POINTS ON PARKING AREA  
(stands coordinates computed in WGS 84)

STANDS	N	E	PCN	STANDS	N	E	PCN	STANDS	N	E	PCN	STANDS	N	E	PCN
1	45°49'22.75"	013°28'59.25"	39	10	45°49'23.87"	013°29'11.84"	64	16 Stop2	45°49'19.44"	013°29'05.52"	109	25	45°49'17.24"	013°28'49.84"	120
2	45°49'23.64"	013°29'00.59"	54	11	45°49'22.10"	013°29'11.54"	64	17	45°49'18.79"	013°29'05.39"	109	26	45°49'21.69"	013°28'48.02"	77
3	45°49'23.43"	013°29'00.90"	54	12	45°49'21.95"	013°29'11.55"	64	18	45°49'18.95"	013°29'01.58"	113	27	45°49'21.86"	013°28'48.26"	77
4	45°49'23.57"	013°29'02.09"	68	13 Stop1	45°49'20.25"	013°29'10.37"	120	19	45°49'18.20"	013°29'02.31"	113	28	45°49'21.84"	013°28'49.25"	77
5	45°49'23.85"	013°29'02.28"	68	13 Stop2	45°49'20.11"	013°29'10.49"	120	20	45°49'18.35"	013°28'58.96"	86	29	45°49'21.95"	013°28'50.22"	77
6	45°49'24.05"	013°29'03.97"	55	14	45°49'19.06"	013°29'07.61"	89	21	45°49'19.25"	013°28'58.53"	120	30	45°49'22.21"	013°28'51.15"	77
7	45°49'23.84"	013°29'04.28"	55	15 Stop1	45°49'19.88"	013°29'07.22"	89	22	45°49'17.93"	013°28'55.50"	120	31	45°49'22.11"	013°28'51.45"	77
8	45°49'23.54"	013°29'05.67"	51	15 Stop2	45°49'19.66"	013°29'07.28"	89	23	45°49'17.66"	013°28'53.31"	120	32	45°49'22.36"	013°28'52.37"	77
9	45°49'24.05"	013°29'11.81"	64	16 Stop1	45°49'19.64"	013°29'05.47"	109	24	45°49'18.47"	013°28'52.41"	120				

<b>AIRCRAFT PARKING DOCKING REMARKS</b>
---

STAND	STOP * POSITION	ACFT CODE	DIMENSIONS RESTRICTIONS	SELF MANOEUVRING	PUSH OR POWER BACK	REMARKS
1	1	C	Max overall length less or equal to 30 m Max wingspan less or equal to 28 m	Yes	Yes	NIL
2	1	C	Max overall length less or equal to 27 m Max wingspan less or equal to 28 m	Not allowed	Yes	Cannot be operated when stand 3 engaged
3	1	B	Max overall length less or equal to 20,5 m Max wingspan less or equal to 20 m	Yes	Yes	Cannot be operated when stand 2 engaged
4	1	B	Max overall length less or equal to 20,5 m Max wingspan less or equal to 20 m	Yes	Yes	Cannot be operated when stand 5 engaged
5	1	C	Max overall length less or equal to 27 m Max wingspan less or equal to 28 m	Not allowed	Yes	Cannot be operated when stand 4 engaged
6	1	C	Max overall length less or equal to 27 m Max wingspan less or equal to 28 m	Not allowed	Yes	Cannot be operated when stand 7 engaged
7	1	B	Max overall length less or equal to 20,5 m Max wingspan less or equal to 20 m	Yes	Yes	Cannot be operated when stand 6 engaged
8	1	C	Max overall length less or equal to 30 m Max wingspan less or equal to 28 m	Yes	Yes	NIL
9	1	B	Max overall length less or equal to 21 m Max wingspan less or equal to 30 m	Yes	Yes	Cannot be operated when stand 10 engaged
10	1	C	Max overall length less or equal to 30 m Max wingspan less or equal to 31 m	Not allowed	Yes	Cannot be operated when stand 9 engaged
11	1	C	Max overall length less or equal to 28 m Max wingspan less or equal to 29 m	Yes	Yes	Cannot be operated when stand 12 engaged
12	1	B	Max overall length less or equal to 21 m Max wingspan less or equal to 30 m	Yes	Yes	Cannot be operated when stand 11 engaged
13	1	C	ACFT A321,B737 equal or lower	Yes	Yes	NIL
	2		ACFT MD80, CRJ900 B727 equal or lower			
14	1	C	NIL	Not allowed	Yes	Cannot be operated when stand 15 engaged
15	1	C	Max overall length less or equal to 39 m Max wingspan less or equal to 28 m	Yes	Yes	Cannot be operated when stand 14 engaged
	2		ACFT Exclusive CRJ900 and EMB145			
16	1	B	Max overall length less or equal to 39 m Max wingspan less or equal to 28 m	Yes	Yes	Cannot be operated when stand 17 engaged
	2		ACFT Exclusive CRJ900 and EMB145			
17	1	C	NIL	Not allowed	Yes	Cannot be operated when stand 16 engaged
18	1	C	NIL	Yes	Yes	Cannot be operated when stand 19 engaged
19	1	E	NIL	Not allowed	Yes	Cannot be operated when stand 18 engaged
20	1	C	NIL	Yes	Yes	Cannot be operated when stand 21 engaged
21	1	D	NIL	Yes	Yes	Cannot be operated when stands 20 or 22 engaged
22	1	C	NIL	Yes	Yes	Cannot be operated when stand 21 engaged

STAND	STOP * POSITION	ACFT CODE	DIMENSIONS RESTRICTIONS	SELF MANOEUVRING	PUSH OR POWER BACK	REMARKS
23	1	C	NIL	Yes	Yes	Cannot be operated when stand 24 engaged
24	1	E	Max wingspan less or equal to 64 m	Yes	Yes	Cannot be operated when stands 23 or 25 engaged
25	1	C	NIL	Yes	Yes	Cannot be operated when stand 24 engaged
26	1	A	Max overall length less or equal to 12 m General Aviation only	Yes	Yes	1) Cannot be operated when stand 27 engaged 2) DAILY SS PLUS30-SR MINUS30, movements of aircraft not allowed due to lack of illumination
27	1	A	General Aviation only	Yes	Yes	1) Cannot be operated when stands 26 or 28 engaged 2) DAILY SS PLUS30-SR MINUS30, movements of aircraft not allowed due to lack of illumination
28	1	A	Max overall length less or equal to 12 m General Aviation only	Yes	Yes	1) Cannot be operated when stand 27 engaged 2) DAILY SS PLUS30-SR MINUS30, movements of aircraft not allowed due to lack of illumination
29	1	A	Max overall length less or equal to 12 m General Aviation only	Yes	Yes	Cannot be operated when stand 30 engaged
30	1	A	General Aviation only	Yes	Yes	Cannot be operated when stands 29 or 31 engaged
31	1	A	Max overall length less or equal to 12 m General Aviation only	Yes	Yes	Cannot be operated when stands 30 engaged
32	1	A	General Aviation only	Yes	Yes	NIL

\*Stop Position 1 or 2 indicate nose wheel position according with aircraft code

TWR 130.205	AD ELEV 40	TRIESTE / RONCHI DEI LEGIONARI	
	APRON ELEV 30	L I P Q	45°49'39"N 013°28'20"E

VAR +2° E-2005,0  
 ↑  
 ↓  
 Annual rate of change 5'E

CHANGE: TWR FREQ

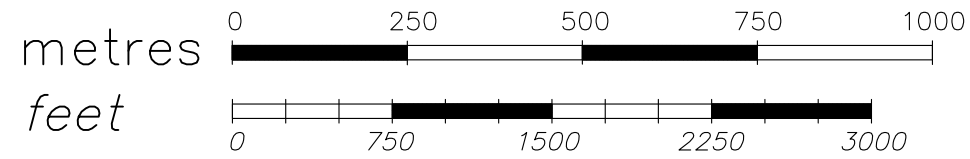
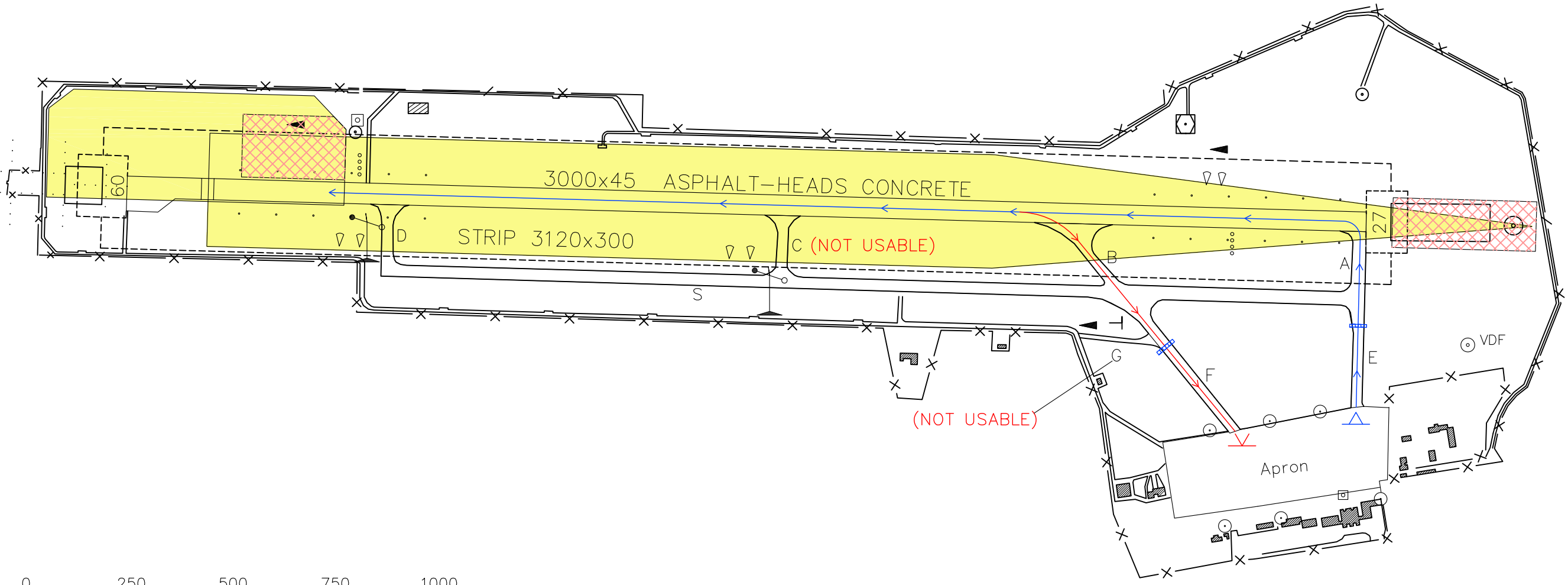

- ABORTED TAKE-OFF RWY 27 VACATE VIA "D" THEN "S" AND "F"  
 - ABORTED TAKE-OFF RWY 09 VACATE VIA "A" THEN "E"

LEGENDA	
ARR	STOP BARS
DEP	FOLLOW-ME POSITION
AREE CRITICHE	FOLLOW-ME POSITION
AREE SENSITIVE	