

| | | | | | |
|-----------------------|--|---------------------|--------------------|-------------------|------------------------------|
| Bearings are magnetic | | TWR/AFIU 119.550 | AD ELEV 1267 | CUNEO / LEVALDIGI | |
| Distances in metres | | | APRON ELEV 1243 | | |
| Elevation in ft AMSL | | | L I M Z | | 44° 32' 51" N 007° 37' 23" E |
| Coordinates WGS84 | | | | | |

| RWY | QFU | THR | bearing strength |
|-----|------|---------------------------------------|------------------|
| 03 | 032° | N 44° 32' 22.74" E 007° 36' 58.36" | PCN 45/F/C/X/T |
| 21 | 212° | N 44° 33' 20.04" E 007° 37' 49.60" | |

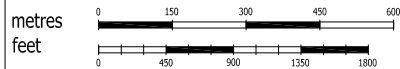

REMARK :

- 1) TWY A AVBL to ACFT MAX code D
- 2) TWY B AVBL to ACFT MAX code B

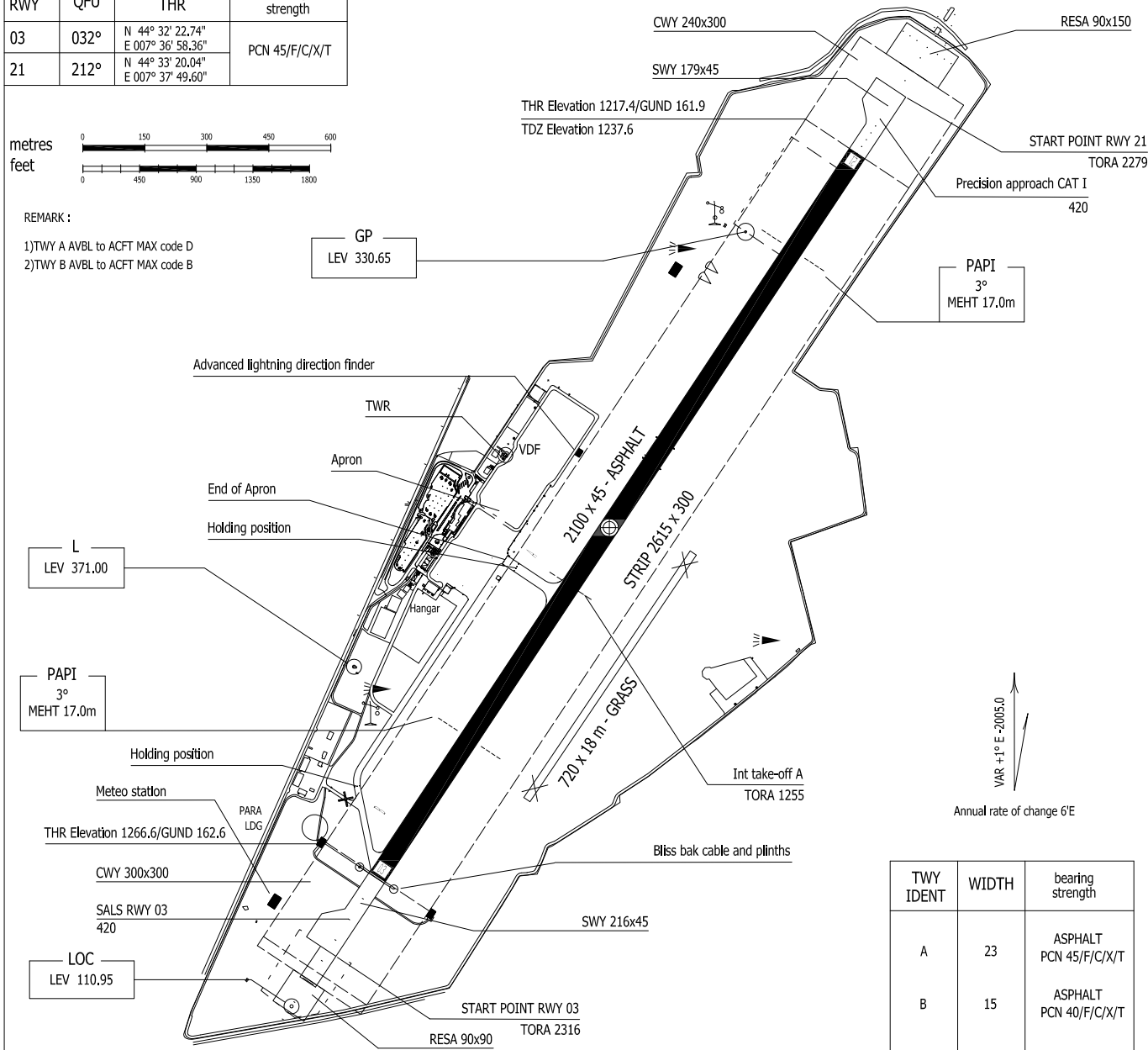

VAR +1° E -2005.0
Annual rate of change 6'E

| TWY IDENT | WIDTH | bearing strength |
|-----------|-------|---------------------------|
| A | 23 | ASPHALT PCN 45/F/C/X/T |
| B | 15 | ASPHALT PCN 40/F/C/X/T |

lighting aids stopway RWY 03

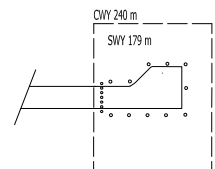

lighting aids stopway RWY 21

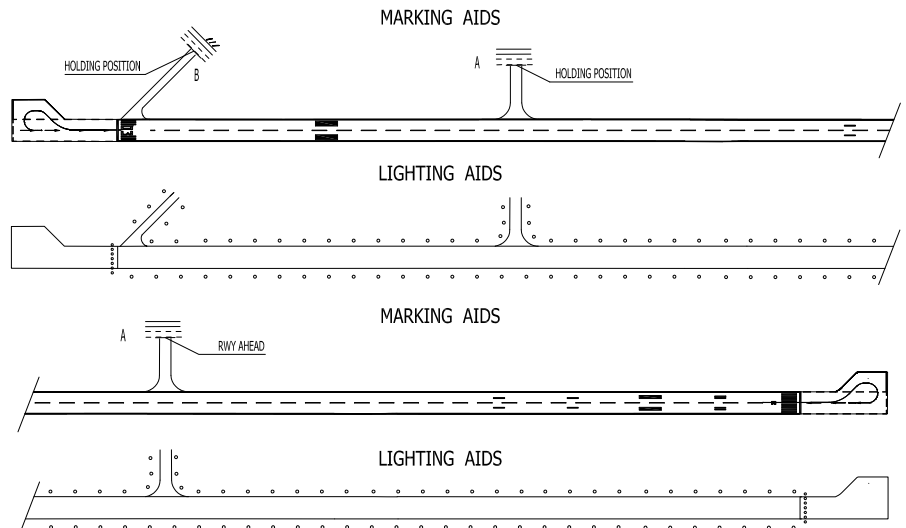
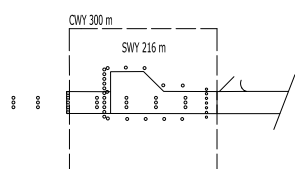

CHANGE: Midpoint transmitters completely withdrawn

| |
|--------------|
| ATC SERVICES |
| TWR/AFIU |
| 119.550 |

| | | | |
|--------------------|-------------------|---------------|----------------|
| AD ELEV 1267 | CUNEO / LEVALDIGI | | |
| APRON ELEV 1243 | L I M Z | 44° 32' 51" N | 007° 37' 23" E |

HOT SPOT AREA

- 1) Apron between TWY A and B
- 2) Men/vehicles must have radio contact with TWR/AFIU on 445.775MHz
- 3) Aircraft moving to/from TWY A and B are requested to contact TWR/AFIU on 119.550MHz
- 4) TWY B for aircraft MAX wing span 24m only

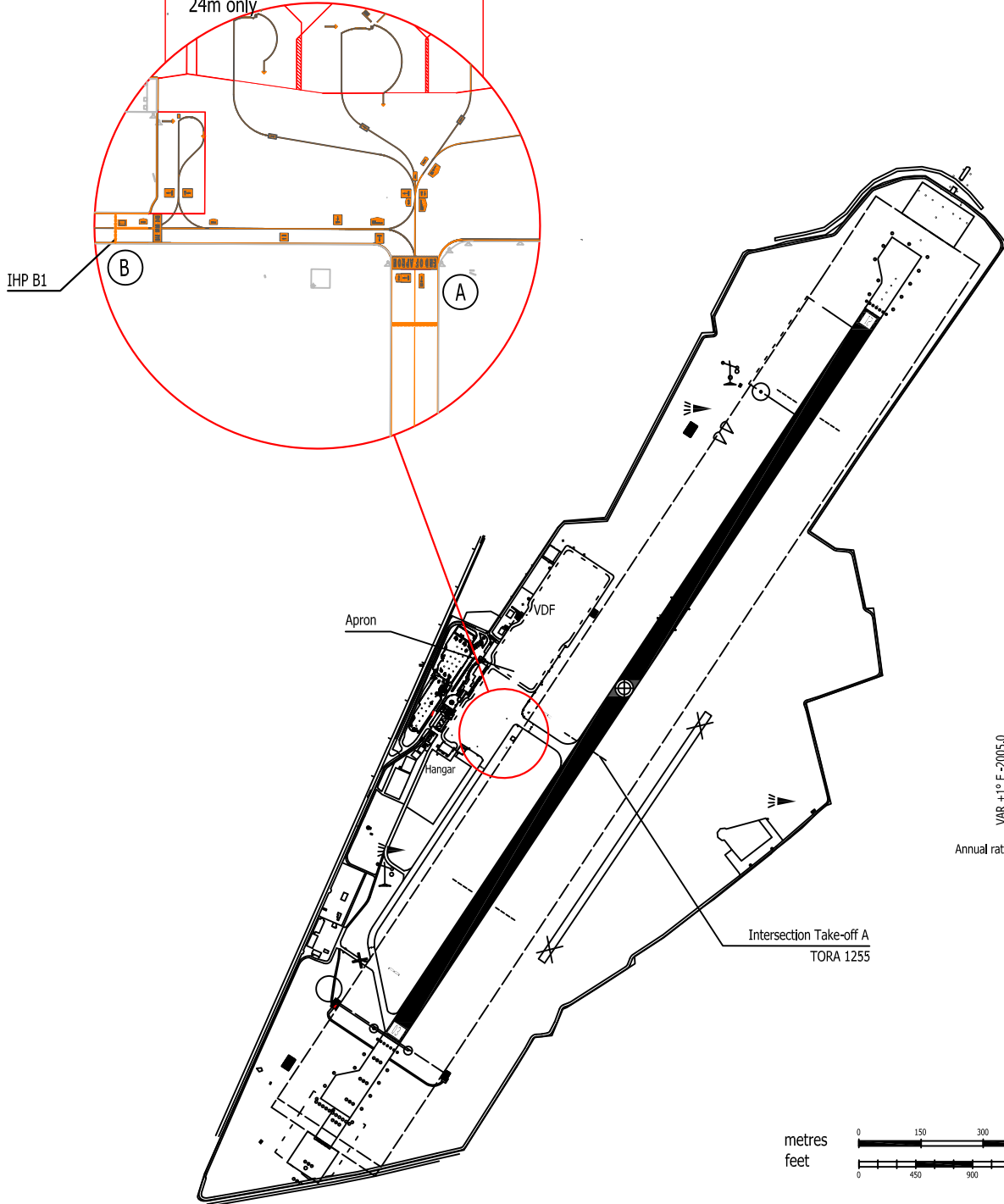

CHANGE: Midpoint transmitters completely withdrawn

Bearings are magnetic
 Distances in metres
 Elevation in ft AMSL
 Coordinates WGS84

TWR/AFIU
 119.550

APRON
 lighting bearing strength

Edge:
 where existing blue
 Surface : asphalt 73665 sqm
 Strength: PCN 85/F/C/X/T

VAR +1° E -2005.0
 Annual rate of change 6'E

AD ELEV
 1267
 APRON ELEV
 1243
CUNEO / LEVALDIGI
 LIMZ
 44° 32' 51" N 007° 37' 23"

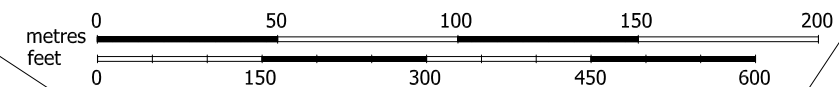

| POINTS ON PARKING AREA | | |
|------------------------|----------------|-----------------|
| STANDS | N | E |
| 2 | 44° 32' 45.76" | 007° 37' 06.48" |
| 3 | 44° 32' 47.66" | 007° 37' 05.44" |
| 4 | 44° 32' 49.10" | 007° 37' 07.01" |
| 5 | 44° 32' 50.81" | 007° 37' 08.52" |
| 6 | 44° 32' 53.13" | 007° 37' 09.70" |
| 7 | 44° 32' 54.20" | 007° 37' 10.83" |
| 8 | 44° 32' 55.45" | 007° 37' 12.65" |
| 9 | 44° 32' 57.07" | 007° 37' 13.72" |
| 10 | 44° 32' 58.65" | 007° 37' 15.15" |
| 11 | 44° 33' 00.23" | 007° 37' 16.57" |
| 12 | 44° 32' 58.56" | 007° 37' 20.31" |
| 13 | 44° 32' 57.36" | 007° 37' 19.24" |
| 14 | 44° 32' 56.16" | 007° 37' 18.17" |
| 15 | 44° 32' 54.96" | 007° 37' 17.09" |
| 16 | 44° 32' 54.06" | 007° 37' 15.64" |
| 17 | 44° 32' 53.38" | 007° 37' 15.46" |
| 18 | 44° 32' 52.53" | 007° 37' 14.70" |
| 19 | 44° 32' 51.68" | 007° 37' 13.93" |
| 20 | 44° 32' 50.82" | 007° 37' 13.17" |

LEGEND

| | |
|------|------------------|
| (12) | SELF MANOEUVRING |
| □ | PUSH BACK |
| △ | DOCKING SYSTEM |

CHANGE: Midpoint transmitters completely withdrawn

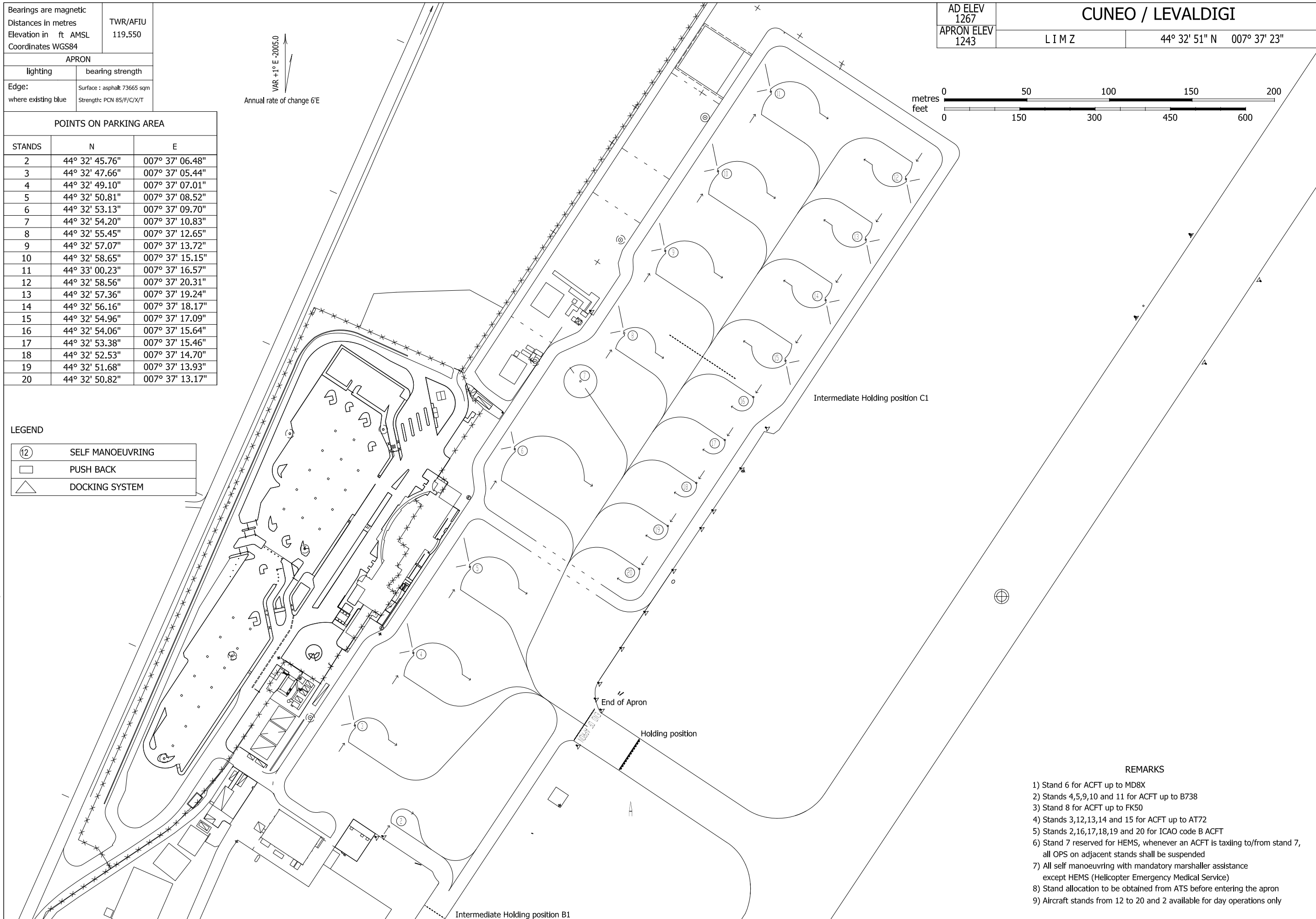

- REMARKS
- Stand 6 for ACFT up to MD8X
 - Stands 4,5,9,10 and 11 for ACFT up to B738
 - Stand 8 for ACFT up to FK50
 - Stands 3,12,13,14 and 15 for ACFT up to AT72
 - Stands 2,16,17,18,19 and 20 for ICAO code B ACFT
 - Stand 7 reserved for HEMS, whenever an ACFT is taxiing to/from stand 7, all OPS on adjacent stands shall be suspended
 - All self manoeuvring with mandatory marshaller assistance except HEMS (Helicopter Emergency Medical Service)
 - Stand allocation to be obtained from ATS before entering the apron
 - Aircraft stands from 12 to 20 and 2 available for day operations only