

Bearings are magnetic		TWR	AD ELEV
Distances in metres		118.975	37
Elevation in ft AMSL		GND	APRON1 ELEV
Coordinates WGS84		121.950	38
		ATIS	APRON2 ELEV
		113.900	38
		PCN 120/F/A/W/T	APRON3 ELEV
			37
RWY	QFU	THR	bearing strength
05	053°	N 40°53'37.18" E 009°30'29.07"	
23	233°	N 40°54'23.11" E 009°31'56.84"	

OLBIA / COSTA SMERALDA		
LIEO	40°53'55" N	009°31'04" E

TWY IDENT	WIDTH (m)	TOTAL WIDTH SHOULDERS INCLUDED (m)	BEARING STRENGTH PCN
A	40	58,5 - 9,25 each side	120/F/A/W/T
B	24	44 - 10 each side	43/F/C/W/T
C	24	43 - 9.5 each side	47/F/C/W/T
D	24	43 - 9.5 each side	61/F/C/W/T
E	24	40 - 8 each side	47/F/C/W/T
F	24	45 - 10,5 each side	140/F/C/W/T
G	24	40 - 8 each side	71/F/C/W/T
H	13	15 - 1 each side	59/F/B/W/T
L	26	47 - 10.5 each side	84/F/C/W/T
M	26	44 - 9 each side	70/F/C/W/T
N	46	56 - 5 each side	126/F/A/W/T
P	30	42 - 6 each side	140/F/A/W/T

CHANGE: Addition Lighting Aids captions

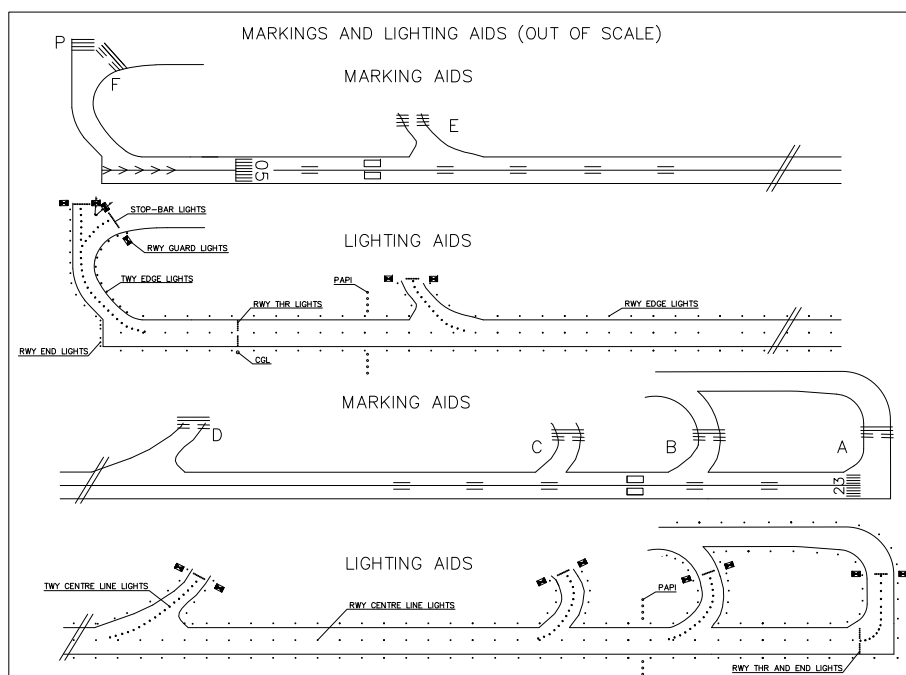
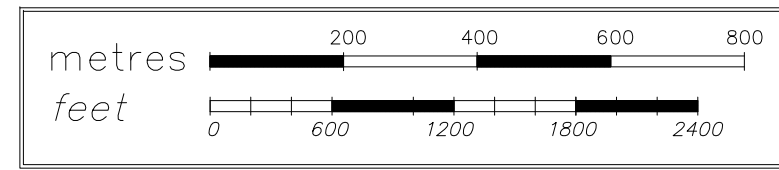
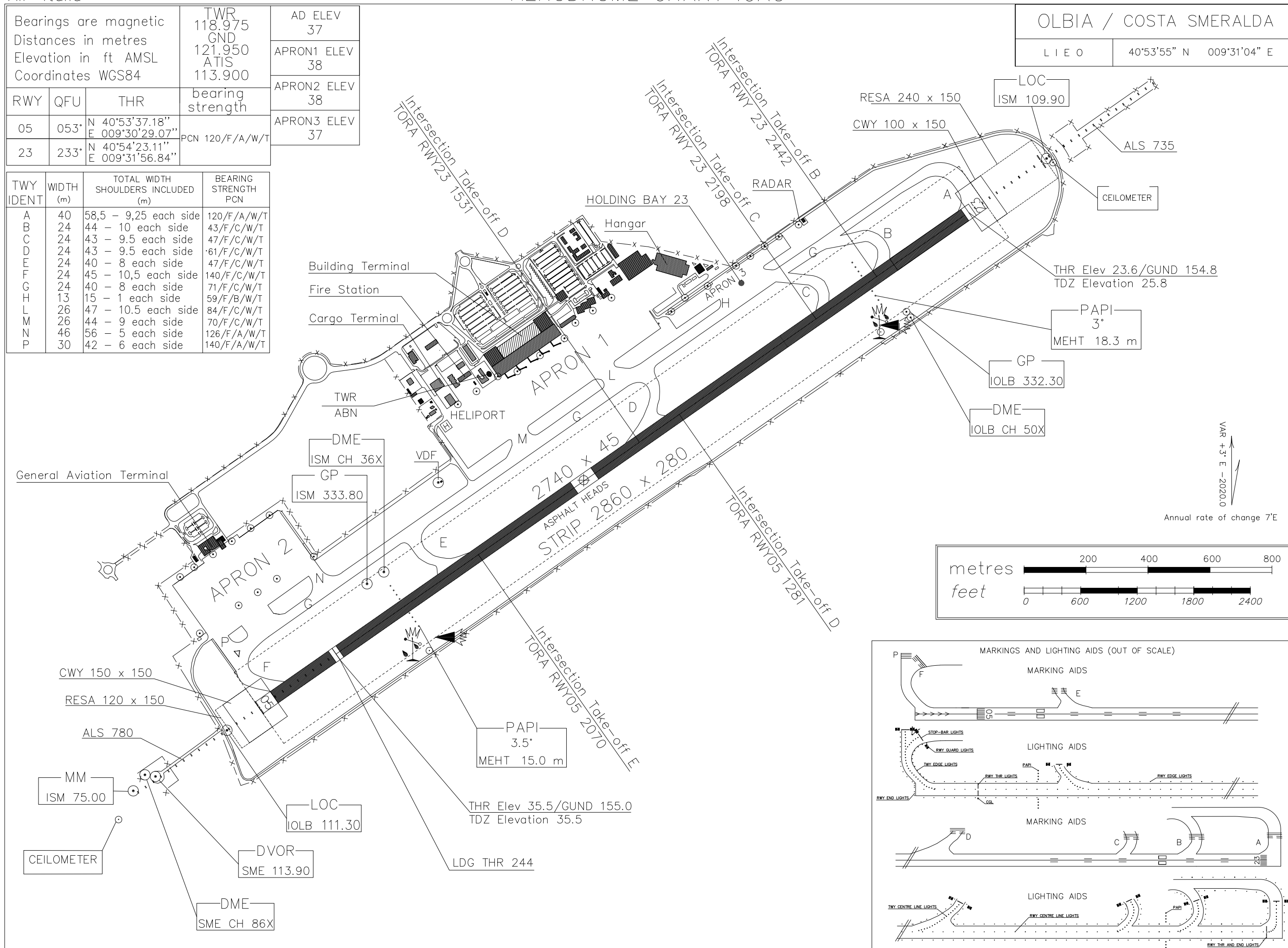

TWR	118.975
GND	121.950
ATIS	113.900

OLBIA / COSTA SMERALDA

L I E O

40°53'55" N 009°31'04" E

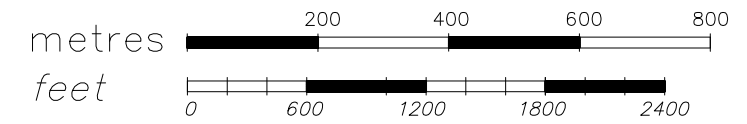

VAR +3. E -2020.0
Annual rate of change 7'E

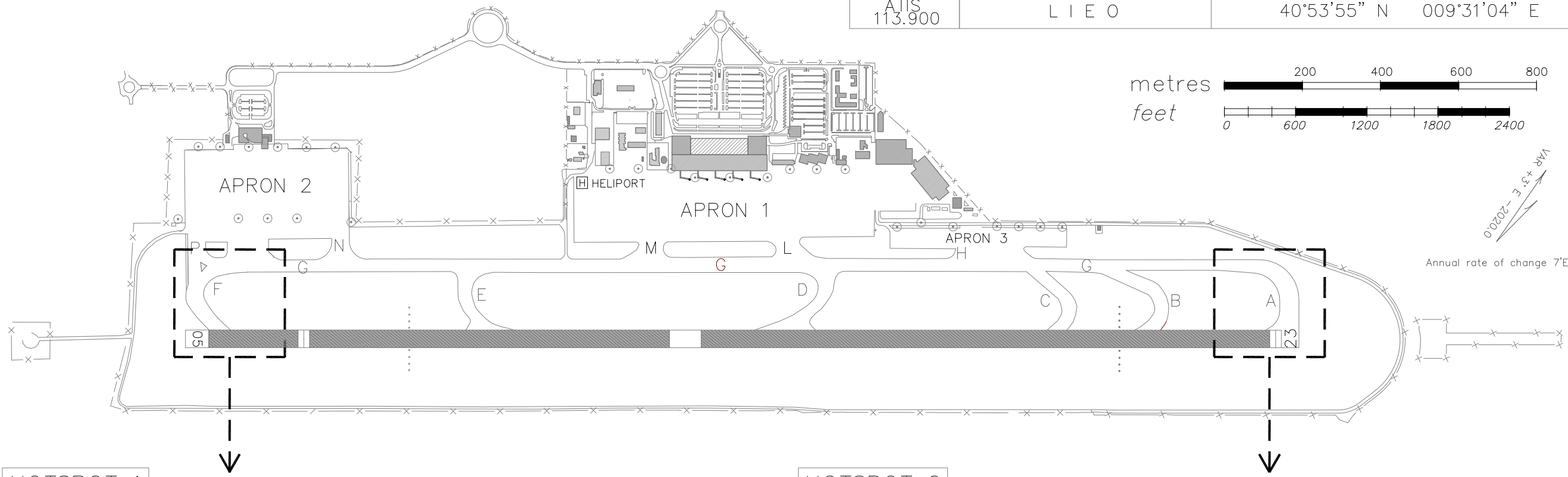

CHANGE: Graphical corrections

HOTSPOT 1

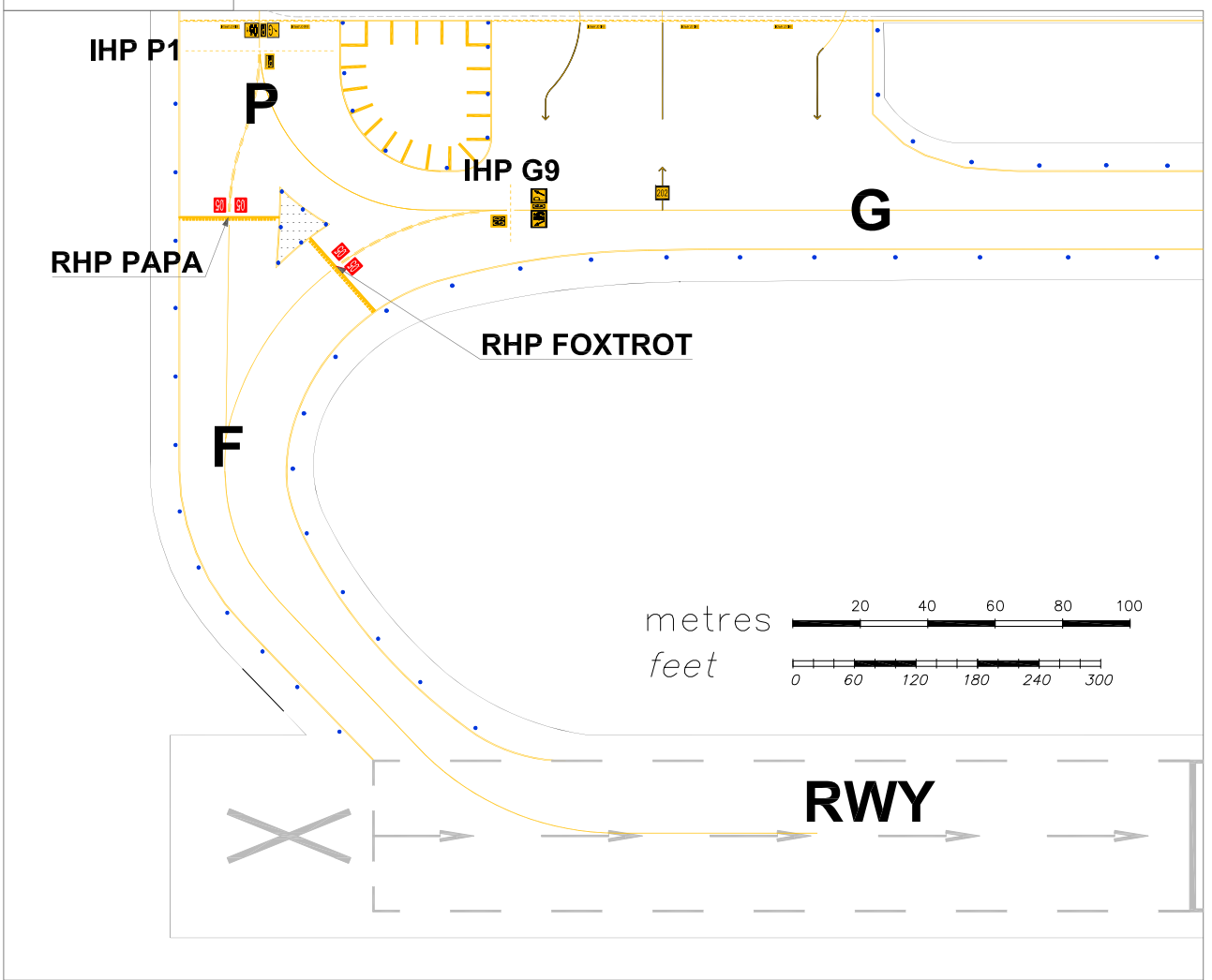

HOTSPOT 2

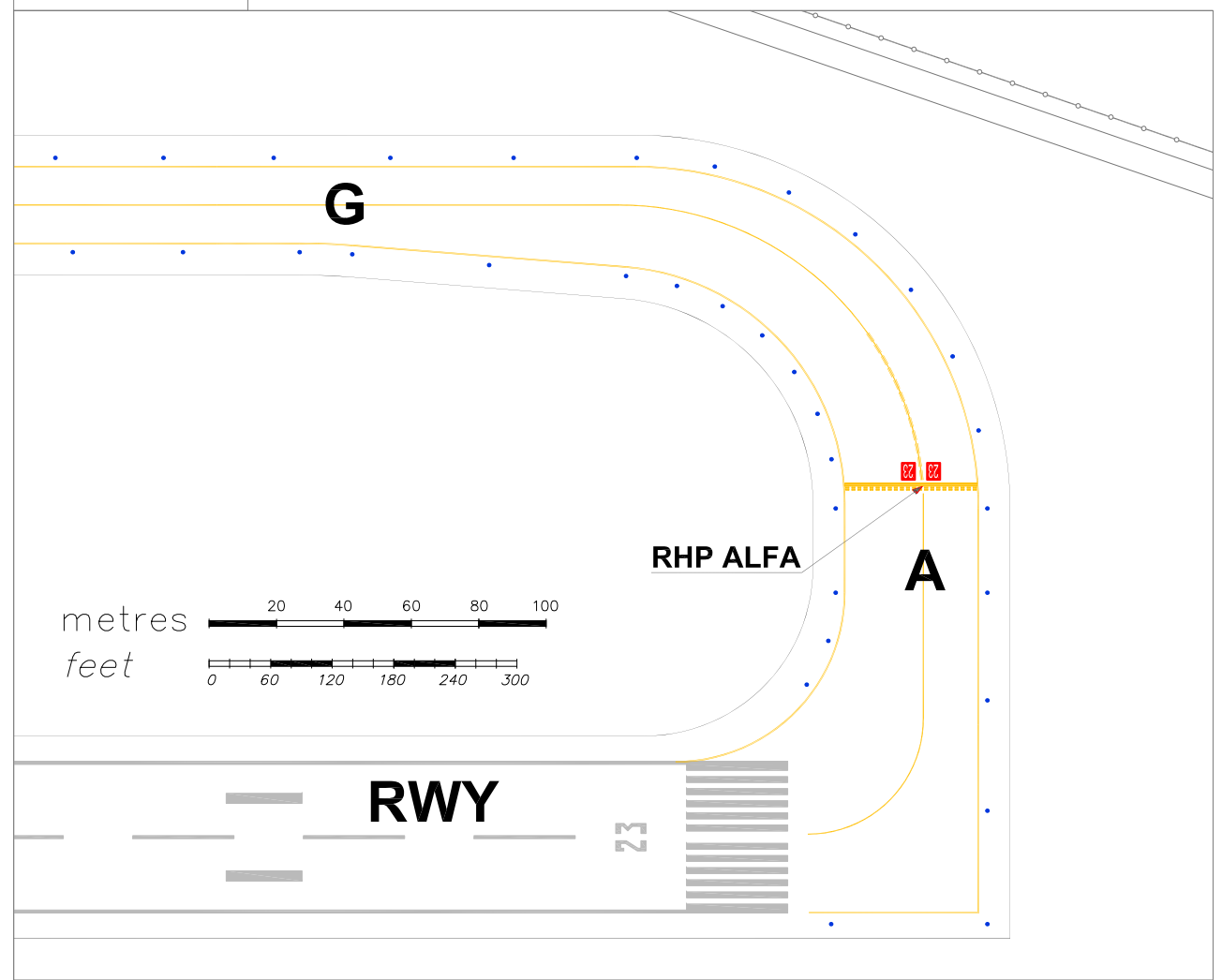

OLBIA / COSTA SMERALDA

TWR
118.975
GND
121.950
ATIS
113.900

L I E O 40°53'55" N 009°31'04" E

APPLICABLE IN REDUCED VISIBILITY CONDITIONS

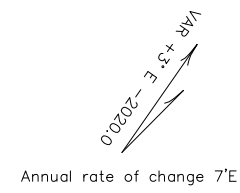
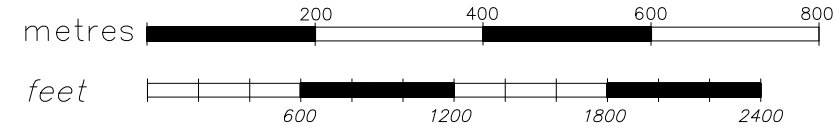

LEGEND

- ACFT DEPARTING ROUTING
- ACFT LANDING/ABORTED TAKE-OFF ROUTING
- FOLLOW-ME POSITION FOR DEPARTURES
- FOLLOW-ME POSITION FOR LANDING/ABORTED TAKE-OFF
- STRIP BOUNDARY
- CRITICAL AREA
- RUNWAY GUARD LIGHTS
- STOP BAR

RUNWAY 05

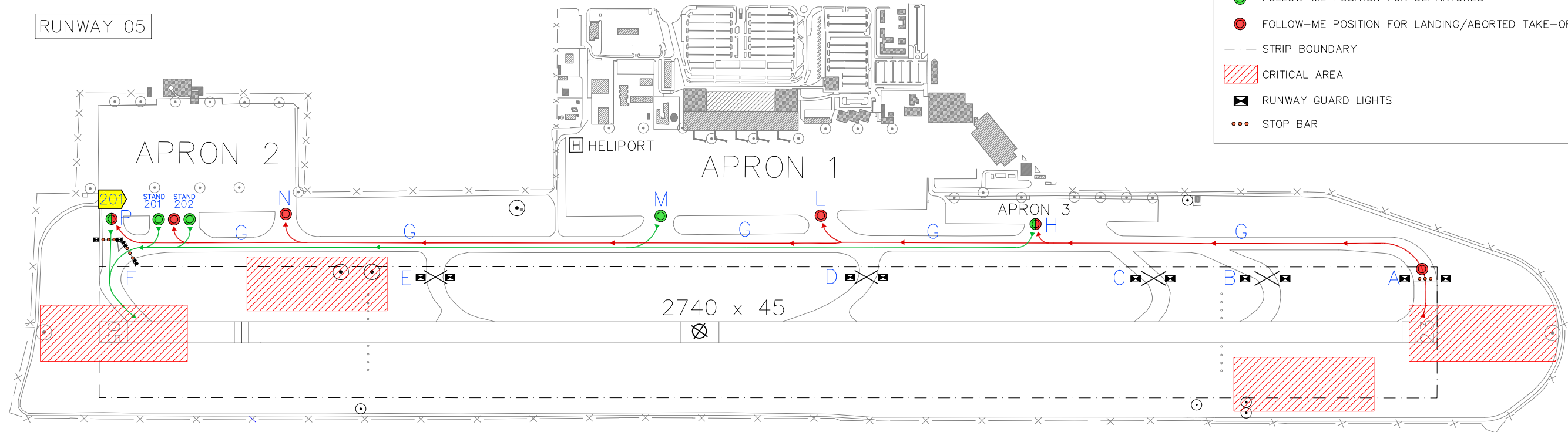

RUNWAY 23

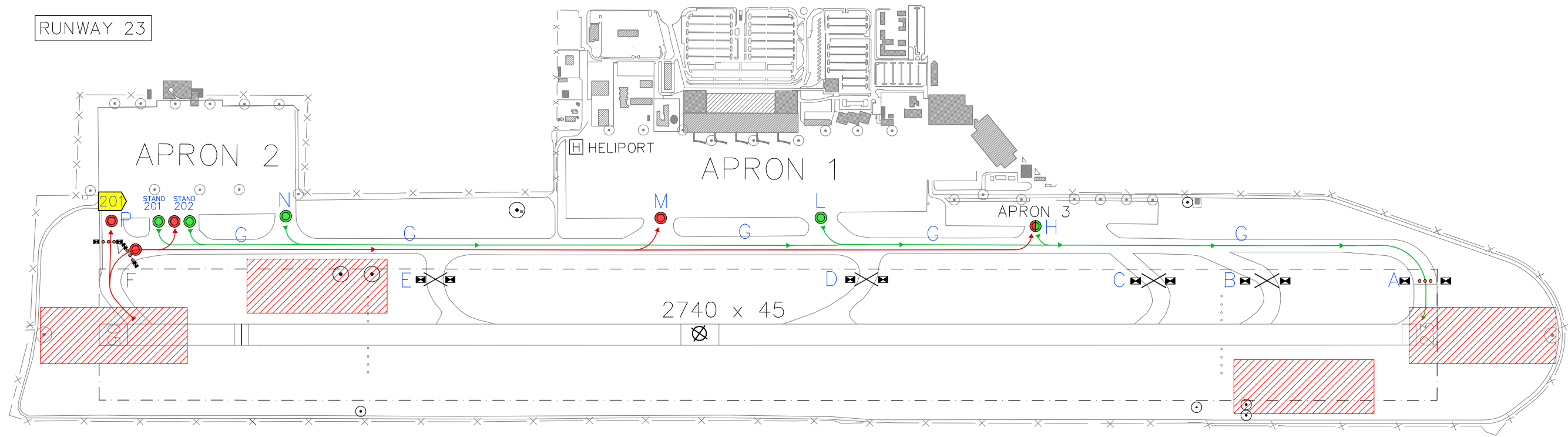

CHANGE: Reduced visibility conditions

Bearings are magnetic
Distances in metres
Elevation in ft AMSL
Coordinates WGS84

TWR
118.975
GND
121.950
ATIS
113.900

APRON 1		APRON 2		APRON 3	
Lighting	Bearing strength	Lighting	Bearing strength	Lighting	Bearing strength
Edge: BLUE	Surface: CONCRETE Strength: PCN 74/R/C/W/T	Edge: BLUE	Surface: CONCRETE Strength: PCN 81/R/C/W/T	Edge: BLUE	Surface: CONCRETE/ASPHALT Strength: STAND 29-37 PCN 49/F/C/W/T Strength: STAND 39-51 PCN 31/R/C/W/T

OLBIA / COSTA SMERALDA

LIEO 40°53'55" N 009°31'04" E

APRON 1			
POINTS ON PARKING AREA			
STANDS		COORD.	
ID	ICAO CODE MAX ACFT ALLOWED	N	E
101	C	40°54'06.62"	009°30'54.61"
102	C	40°54'07.44"	009°30'56.29"
103	C	40°54'08.31"	009°30'57.78"
104	C	40°54'09.10"	009°30'59.35"
105	C	40°54'09.97"	009°31'00.90"
106	C	40°54'06.03"	009°31'04.30"
107	C	40°54'04.88"	009°31'01.92"
108	C	40°54'03.60"	009°30'59.64"
109	C	40°54'02.48"	009°30'57.33"
110	D	40°53'59.90"	009°30'52.43"
111	D	40°53'58.30"	009°30'49.43"
113	C	40°54'03.17"	009°30'47.92"
114	C	40°54'04.32"	009°30'50.38"
115	C	40°54'05.31"	009°30'52.17"
116	C	40°54'11.31"	009°31'03.96"
117	C	40°54'12.50"	009°31'06.23"
118	GULFSTREAM V	40°54'13.61"	009°31'08.09"
119	GULFSTREAM V	40°54'14.74"	009°31'09.65"
21	KING AIR B100	40°54'08.88"	009°31'07.73"
22	KING AIR B100	40°54'08.34"	009°31'08.26"
23	KING AIR B100	40°54'09.53"	009°31'09.02"
24	KING AIR B100	40°54'09.08"	009°31'09.50"
25	KING AIR B100	40°54'10.24"	009°31'10.36"
26	KING AIR B100	40°54'09.62"	009°31'10.83"
27	KING AIR B100	40°54'10.93"	009°31'11.68"
28	KING AIR B100	40°54'10.41"	009°31'12.18"
HEMS	AW139	40°54'01.36"	009°30'44.46"

APRON 2			
POINTS ON PARKING AREA			
STANDS		COORD.	
ID	MAX ACFT ALLOWED	N	E
201	B 767-300	40°53'40.54"	009°30'15.52"
202	B 767-300	40°53'42.38"	009°30'18.96"
203	B 737 - BBJ2	40°53'43.45"	009°30'20.66"
204	B 737 - BBJ2	40°53'44.83"	009°30'23.31"
205	CESSNA CITATIONJET	40°53'42.39"	009°30'11.34"
206	CESSNA CITATIONJET	40°53'42.88"	009°30'12.27"
207	CESSNA CITATIONJET	40°53'43.46"	009°30'13.36"
208	CESSNA CITATIONJET	40°53'44.06"	009°30'14.51"
209	CESSNA CITATIONJET	40°53'44.67"	009°30'15.66"
210	FALCON 900 B	40°53'42.79"	009°30'10.94"
211	GULFSTREAM V	40°53'44.34"	009°30'08.86"
212	FALCON 900 B	40°53'43.38"	009°30'12.29"
213	GULFSTREAM V	40°53'45.44"	009°30'10.99"
214	FALCON 900 B	40°53'44.00"	009°30'13.42"
215	B 737 - BBJ2	40°53'46.65"	009°30'13.14"
216	FALCON 900 B	40°53'44.61"	009°30'14.59"
217	B 737 - BBJ2	40°53'48.35"	009°30'13.94"
218	FALCON 900 B	40°53'45.22"	009°30'15.74"
219	GULFSTREAM V	40°53'48.69"	009°30'15.60"
220	B 737 - BBJ	40°53'45.55"	009°30'17.56"
221	GULFSTREAM V	40°53'49.54"	009°30'17.30"
222	B 737 - BBJ	40°53'46.30"	009°30'19.01"
223	GULFSTREAM V	40°53'50.40"	009°30'18.95"
224	B 737 - BBJ	40°53'47.07"	009°30'20.45"
225	GULFSTREAM V	40°53'51.27"	009°30'20.60"
226	GLOBAL EXPRESS	40°53'47.92"	009°30'21.83"

APRON 3							
POINTS ON PARKING AREA							
STANDS		COORD.		STANDS		COORD.	
ID	MAX ACFT ALLOWED	N	E	ID	MAX ACFT ALLOWED	N	E
29	PA 42-1000	40°54'11.83"	009°31'16.25"	41	TB-10	40°54'18.73"	009°31'28.19"
30	PA 42-1000	40°54'12.16"	009°31'16.89"	42	TB-10	40°54'19.08"	009°31'28.86"
31	PA 42-1000	40°54'12.49"	009°31'17.52"	43	TB-10	40°54'19.42"	009°31'29.53"
32	PA 42-1000	40°54'12.83"	009°31'18.15"	44	TB-10	40°54'19.71"	009°31'30.05"
33	PA 42-1000	40°54'13.16"	009°31'18.78"	45	TB-10	40°54'20.11"	009°31'30.78"
34	PA 42-1000	40°54'13.44"	009°31'19.40"	46	TB-10	40°54'19.31"	009°31'31.56"
35	PA 42-1000	40°54'13.82"	009°31'20.04"	47	TB-10	40°54'18.96"	009°31'30.91"
36	PA 42-1000	40°54'14.15"	009°31'20.68"	48	TB-10	40°54'18.62"	009°31'30.26"
37	PA 42-1000	40°54'14.43"	009°31'21.39"	49	TB-10	40°54'18.27"	009°31'29.58"
39	TB-10	40°54'18.04"	009°31'26.90"	50	TB-10	40°54'17.94"	009°31'28.94"
40	TB-10	40°54'18.38"	009°31'27.54"	51	TB-10	40°54'17.60"	009°31'28.28"

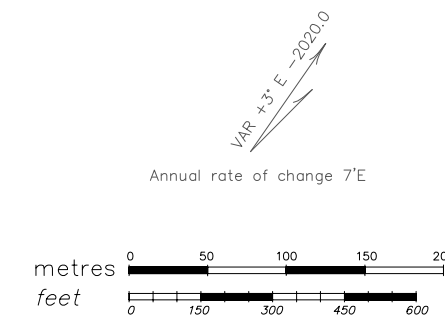
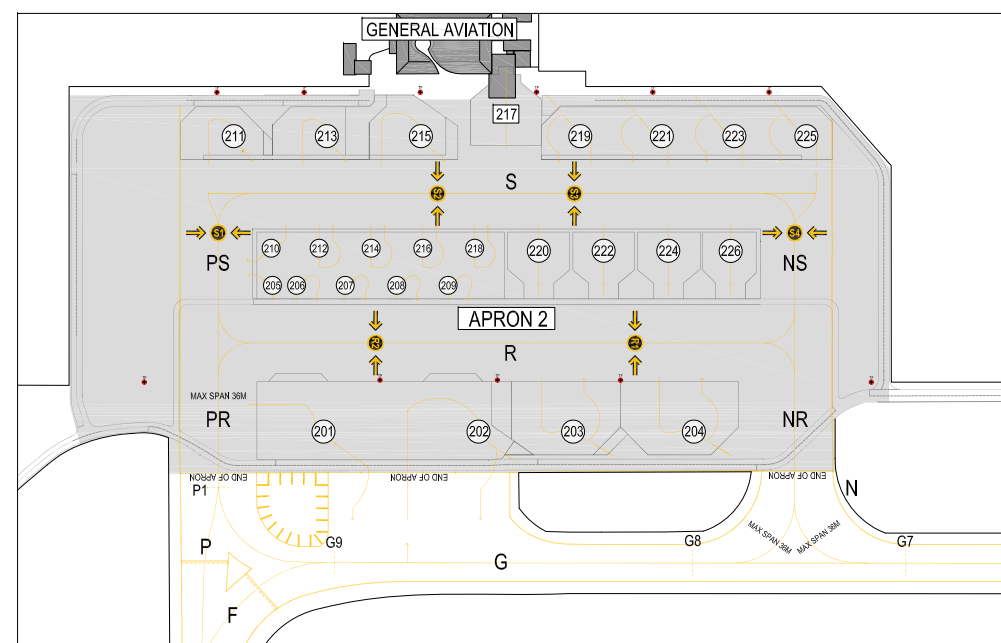

CHANGE: Graphical corrections

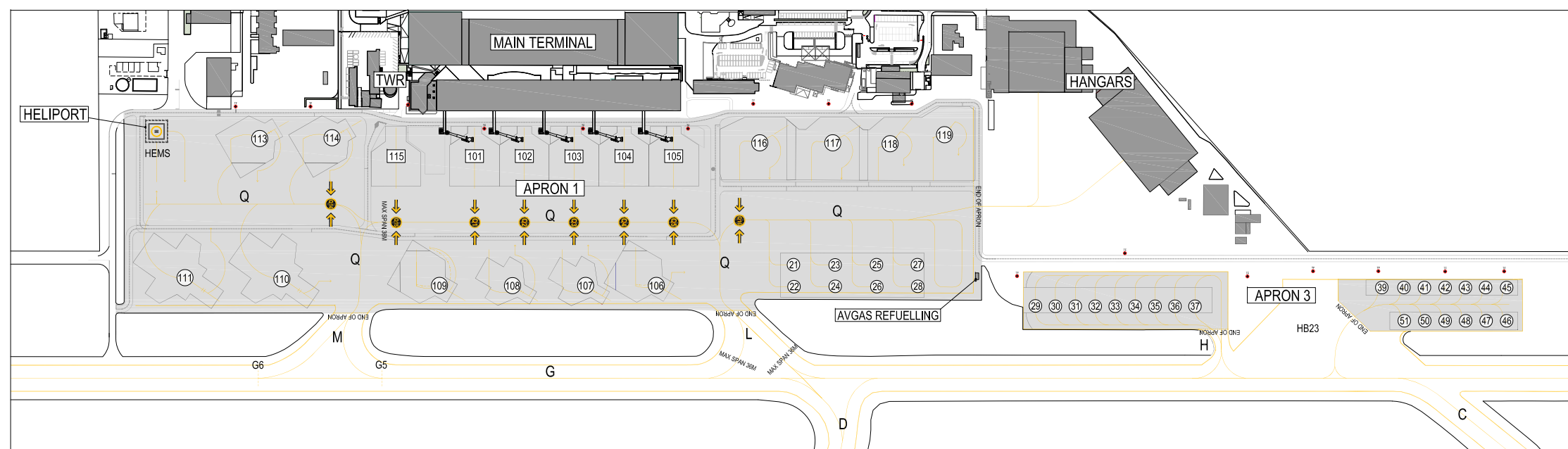

LEGEND

- 114 SELF MANOEUVRING
- 115 PUSH BACK
- APRON
- BUILDING
- ↔ Q1 ↔ START ENGINE POINT
- ⊕ LIGHTING TOWER