

AD ELEV
11
APRON ELEV
13

CAGLIARI / ELMAS

L I E E 39°14'50" N 009°03'22" E

Bearings are magnetic
Distances in metres
Elevation in ft AMSL
Coordinates WGS84

TWR	120.605	122.100
GND	125.430	
ATIS	127.055	

RWY	QFU	THR	bearing	strength
14	137°	N 39°15'39.02'' E 009°02'36.33''	PCN 102/F/A/X/T	
32	317°	N 39°14'31.48'' E 009°03'54.63''		

VAR +1° E-2010.1

Annual rate of change 5' E

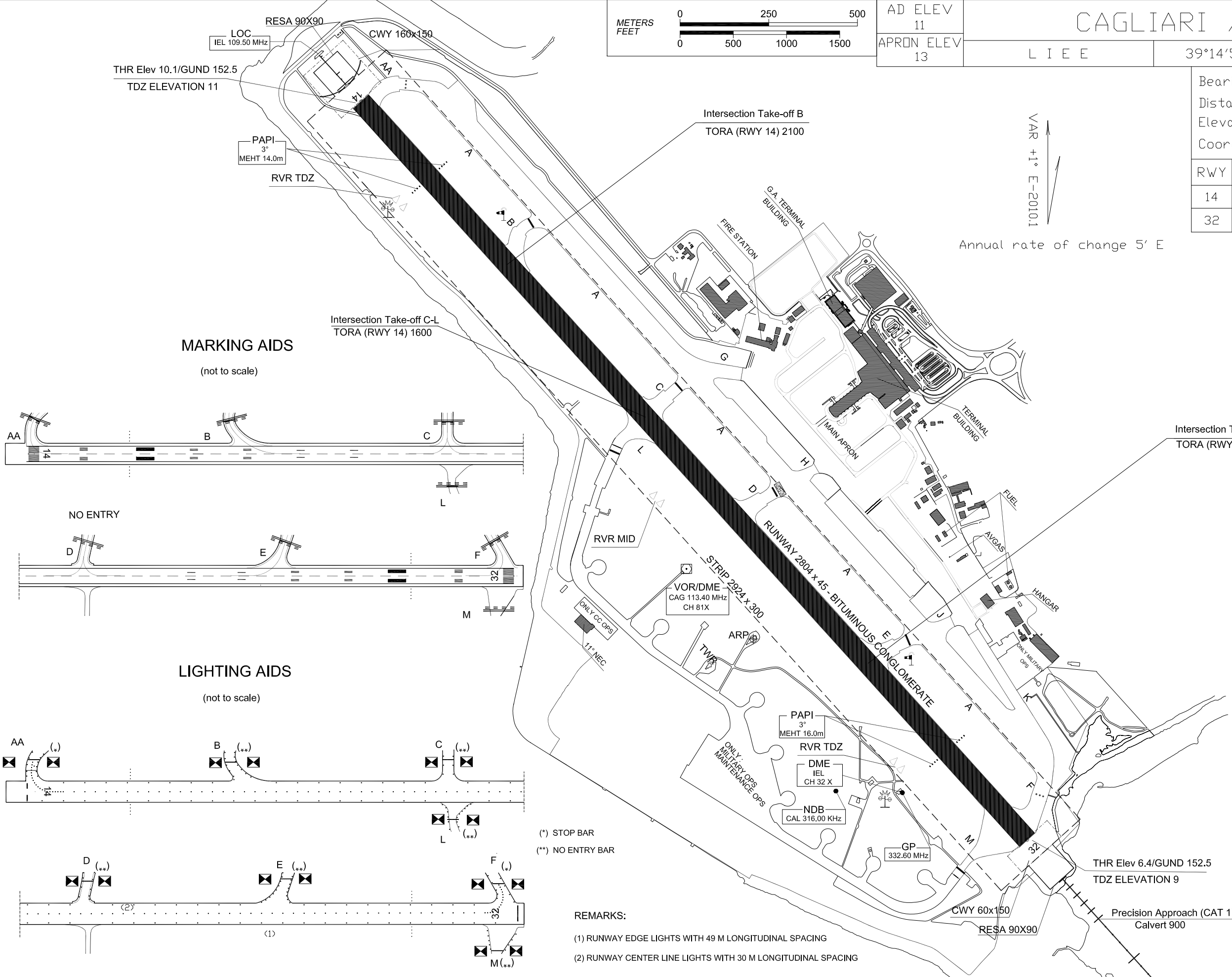

MARKING AIDS

(not to scale)

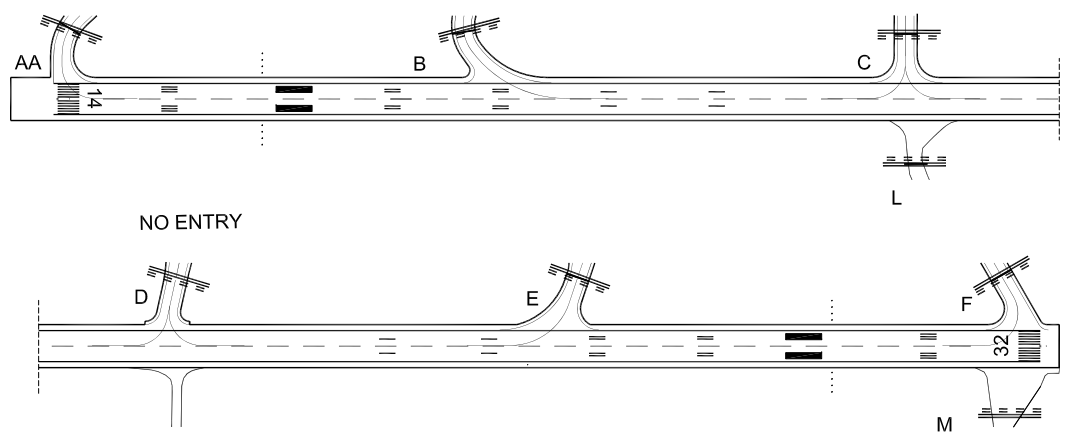

LIGHTING AIDS

(not to scale)

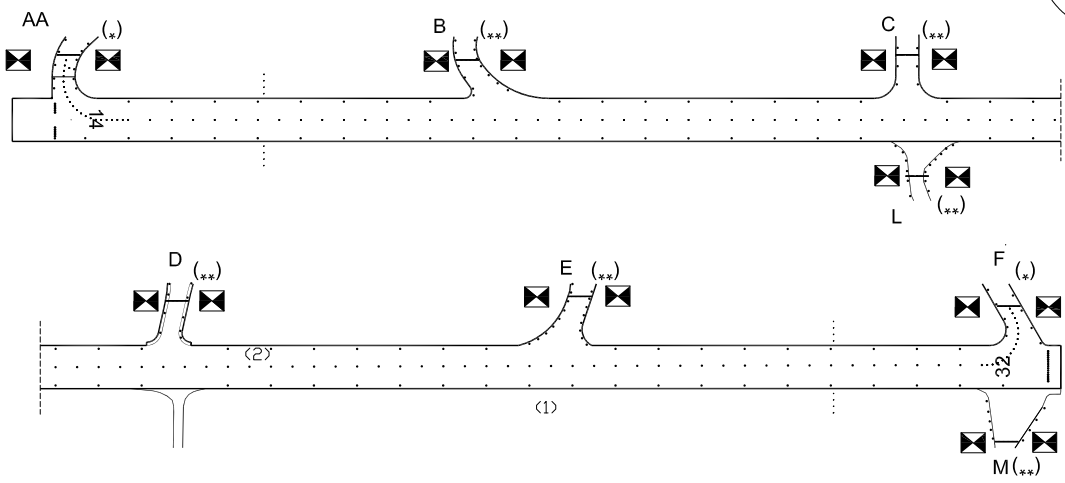

(*) STOP BAR
(**) NO ENTRY BAR

REMARKS:

- (1) RUNWAY EDGE LIGHTS WITH 49 M LONGITUDINAL SPACING
- (2) RUNWAY CENTER LINE LIGHTS WITH 30 M LONGITUDINAL SPACING

TWY IDENT	WIDTH	BEARING STRENGTH
AA	23	PCN 135/F/A/W/T
A	44	PCN 145/F/B/W/T
B	23	PCN 131/F/A/W/T
C	24	PCN 87/F/C/W/T
D	23	PCN 189/F/B/W/T
E	23	PCN 71/F/C/W/T
F	23	PCN 200/F/A/W/T
G	28	PCN 81/F/A/W/T
H	20	PCN 153/F/A/W/T
J	23	PCN 153/F/C/W/T
K	23	PCN 150/F/A/W/T
L	17	PCN 187/F/B/W/T
M	23	PCN 186/F/A/W/T

CHANGE: TWY M WIDTH AND BEARING STRENGTH AND UPDATED CHART

TWR 120.605 122.100	AD ELEV 11
GND 125.430	APRON ELEV 13
ATIS 127.055	

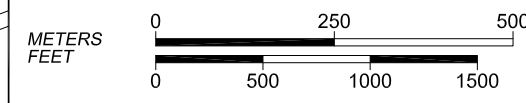

CAGLIARI / ELMAS

L I E E

39°14'50" N 009°03'22" E

VAR +1° E-2010.1

Annual rate of change 5' E

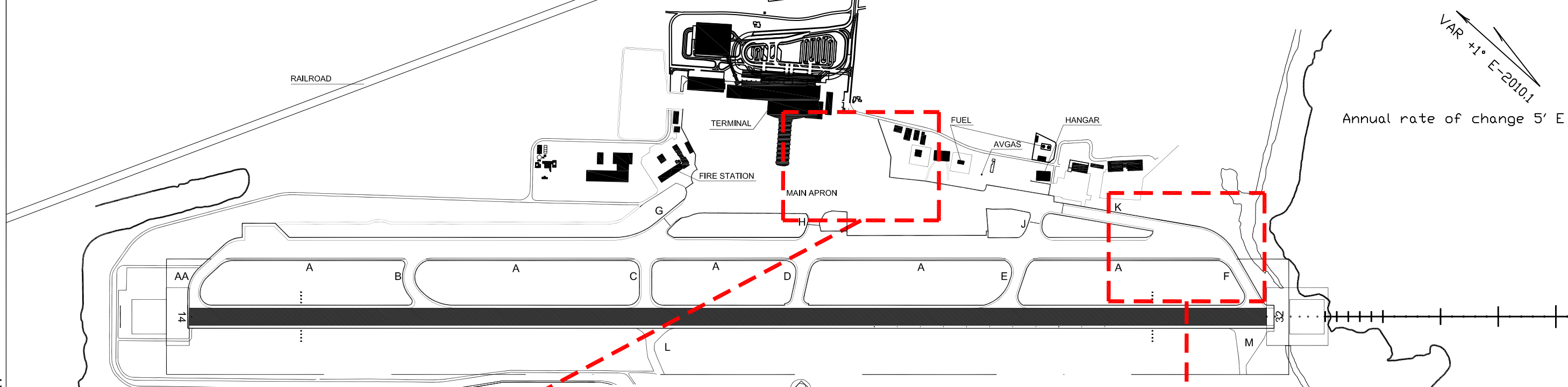

CHANGE: UPDATED CHART

HOT SPOT

HOT SPOT

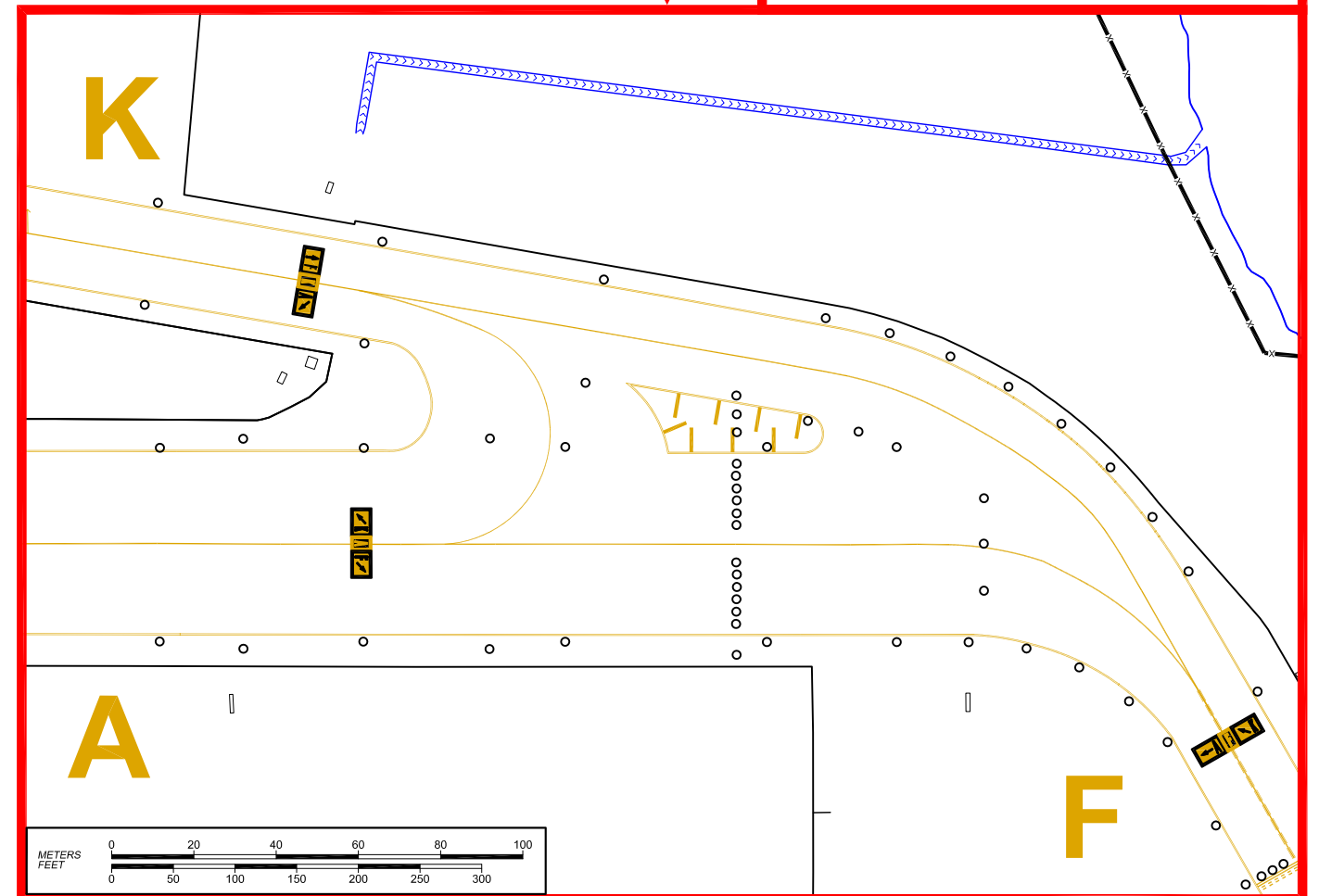
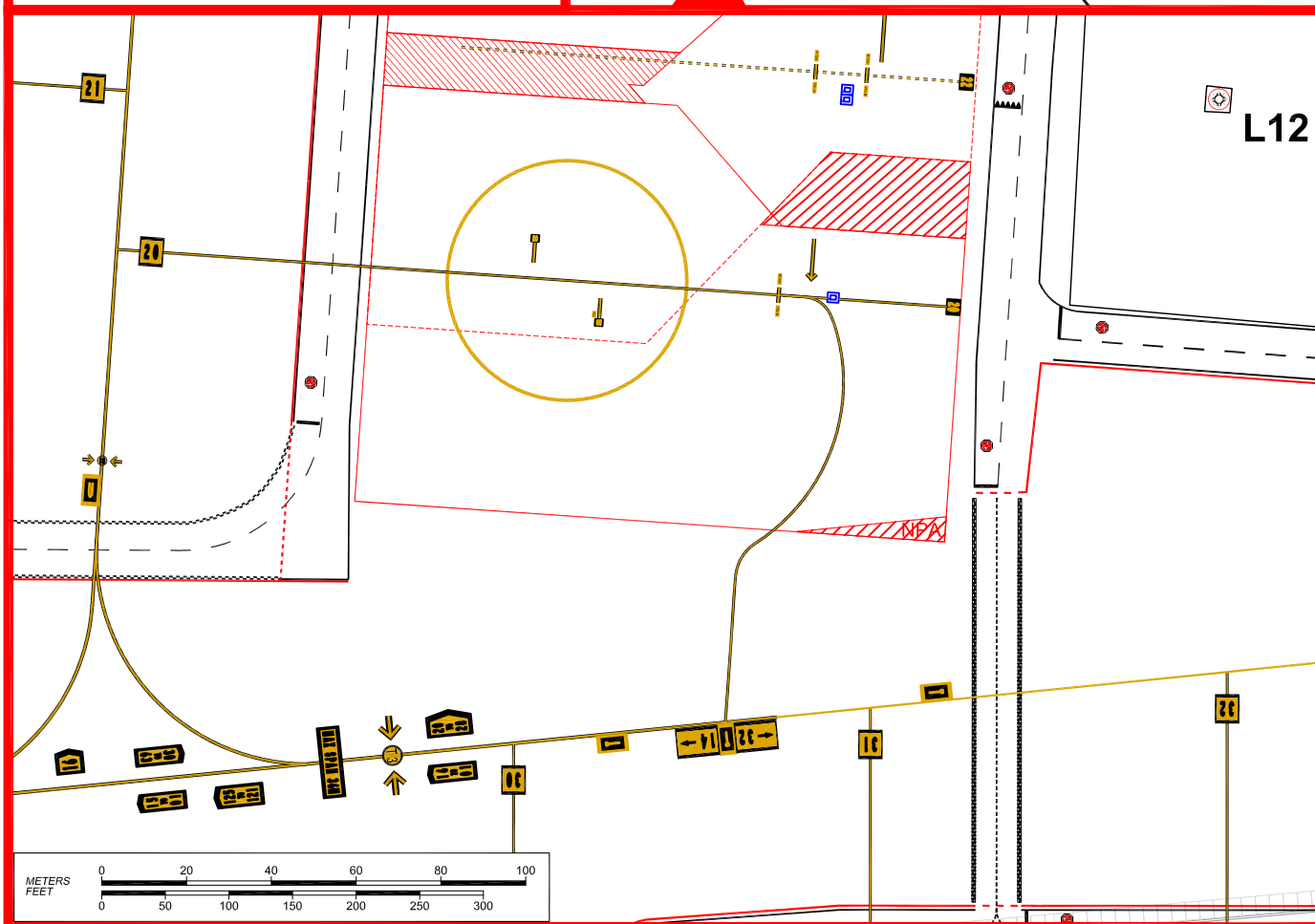

TWR 120.605 122.100	AD ELEV 11
GND 125.430 ATIS 127.055	APRON ELEV 13

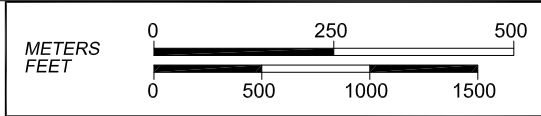

CAGLIARI / ELMAS

L I E E

39°14'50" N 009°03'22" E

VAR +1° E/2010.1

Annual rate of change 5' E

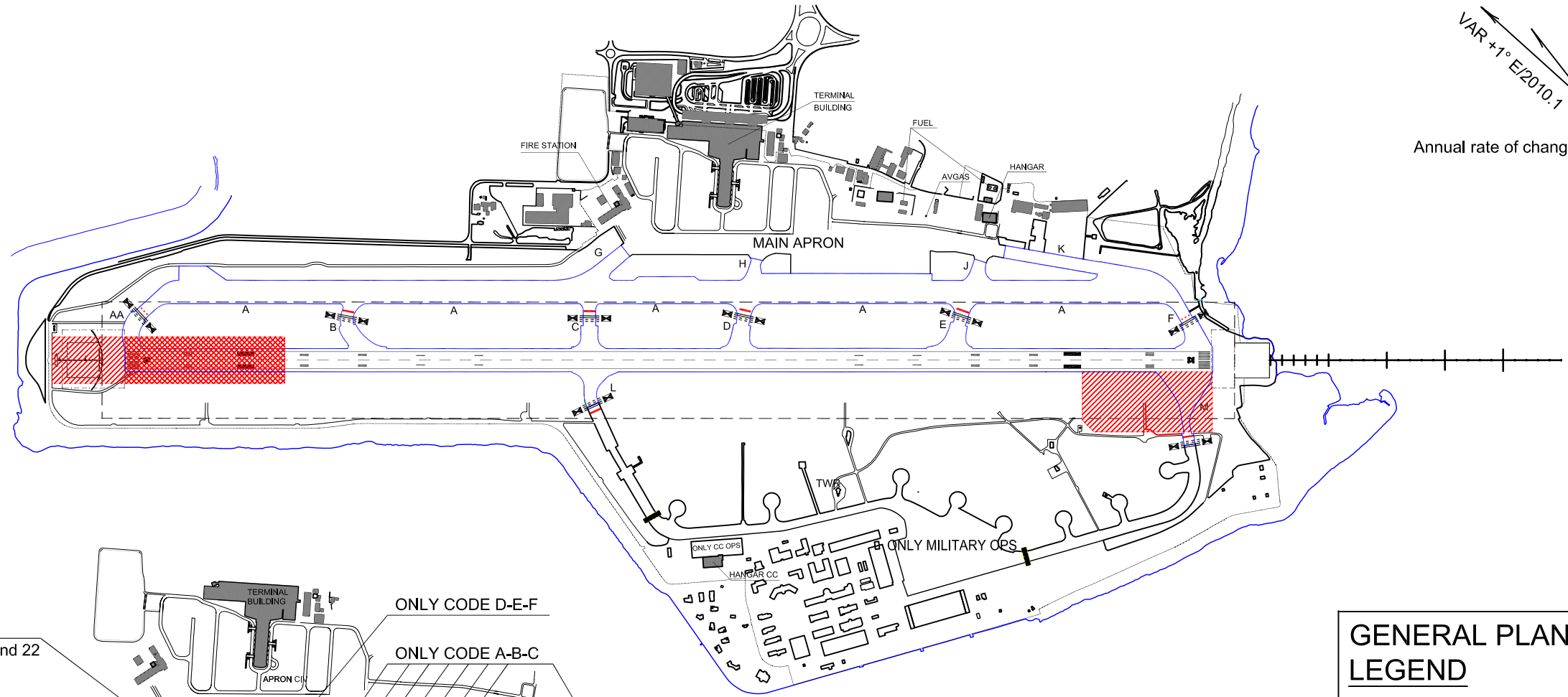

CHANGE: UPDATED CHART

TO/FROM APRON

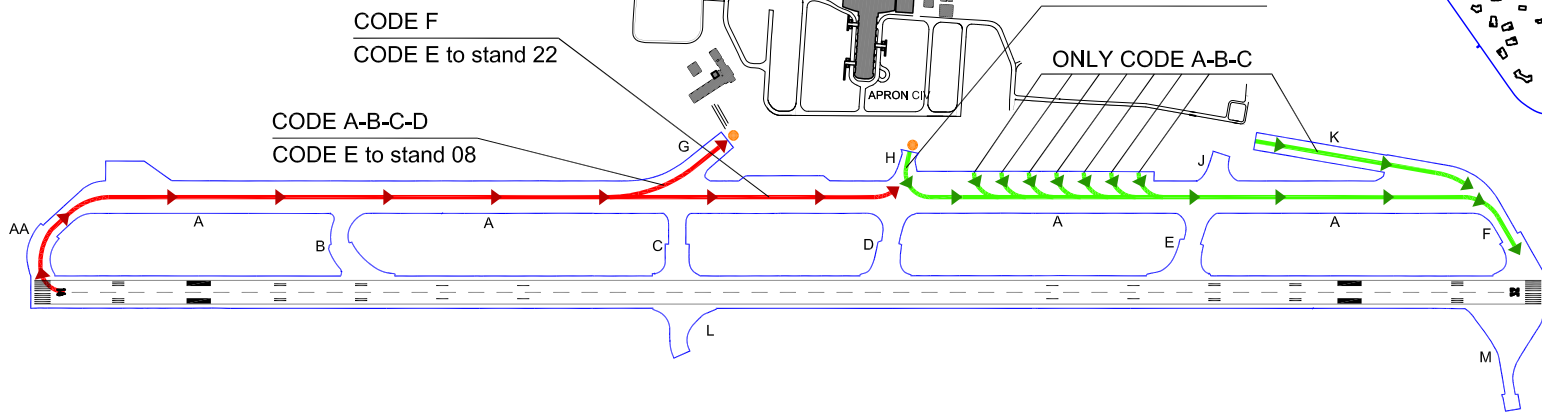

TO/FROM WEST SIDE FOR ONLY MILITARY AND CC OPS

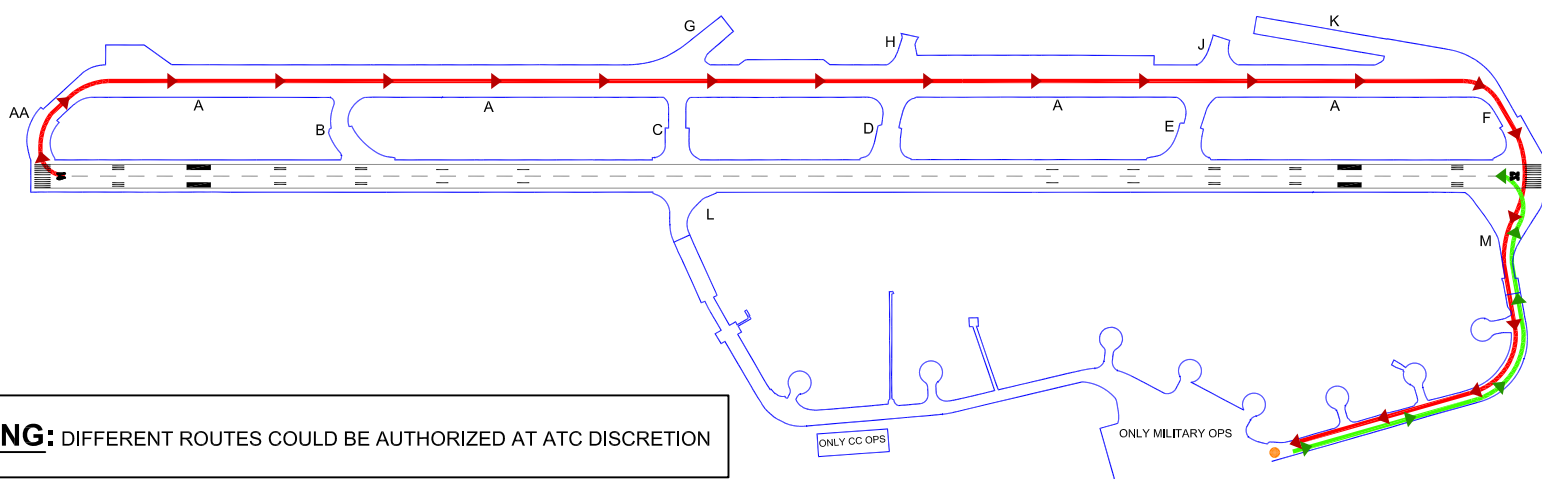

GENERAL PLAN LEGEND

- NO ENTRY BAR
- STOP BAR
- RHP VMC / CAT I
- CRITICAL AREA
- SENSITIVE AREA
- RUNWAY STRIP BOUNDARY

RUNWAY 32 LEGEND

- LANDING AND T.O. ABORTED AIRCRAFT ROUTING
- DEPARTING AIRCRAFT ROUTING
- FOLLOW-ME POSITION

WARNING: DIFFERENT ROUTES COULD BE AUTHORIZED AT ATC DISCRETION

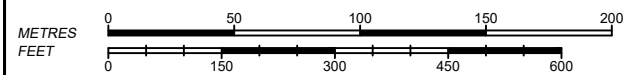

Bearings are magnetic
Distances in metres
Elevations in feet AMSL
Coordinates WGS84

TWR
120.605 122.100
GND
125.430
ATIS
127.055

APRON		
Lighting	Bearing strength	Stands: 22 wide body (code F) 08 code E 05 - 09 - 11 - 20 code D 02-20-30-63 avbl for helicopters 02 avlb for de-icing facilities Apron 226785 sq m
Edge : NIL	Surface : CONCRETE Strength:PCN 209 R/C/W/T	

AD ELEV 11	APRON ELEV 13	LIEE	CAGLIARI / ELMAS 39° 14' 50" N 009° 03' 22" E
---------------	------------------	------	---

POINTS ON PARKING AREA HELICOPTERS

STANDS	N	E
02	39° 15' 14.39"	009° 03' 24.41"
20	39° 15' 04.75"	009° 03' 36.76"
30	39° 15' 02.26"	009° 03' 32.73"
63	39° 14' 52.48"	009° 03' 49.15"

POINTS ON PARKING AREA

STANDS	N	E	STANDS	N	E
01	39° 15' 11.28"	009° 03' 29.32"	24	39° 15' 05.95"	009° 03' 37.88"
02	39° 15' 15.04"	009° 03' 23.76"	25	39° 15' 09.83"	009° 03' 34.98"
03	39° 15' 15.64"	009° 03' 25.28"	26	39° 15' 06.29"	009° 03' 40.20"
04	39° 15' 15.54"	009° 03' 25.84"	27	39° 15' 10.64"	009° 03' 36.31"
05	39° 15' 12.00"	009° 03' 30.45"	28	39° 15' 07.01"	009° 03' 39.62"
06	39° 15' 16.99"	009° 03' 27.32"	30	39° 15' 02.01"	009° 03' 32.37"
07	39° 15' 12.90"	009° 03' 32.07"	31	39° 15' 00.79"	009° 03' 33.79"
08	39° 15' 12.96"	009° 03' 32.86"	32	39° 14' 59.57"	009° 03' 35.21"
09	39° 15' 18.32"	009° 03' 28.45"	33	39° 14' 58.34"	009° 03' 36.63"
10	39° 15' 17.04"	009° 03' 29.32"	34	39° 14' 57.12"	009° 03' 38.05"
11	39° 15' 13.91"	009° 03' 33.58"	35	39° 14' 55.89"	009° 03' 39.47"
121	39° 15' 20.93"	009° 03' 24.61"	36	39° 14' 56.47"	009° 03' 40.89"
122	39° 15' 21.68"	009° 03' 25.84"	50	39° 14' 56.47"	009° 03' 46.01"
123	39° 15' 23.25"	009° 03' 28.42"	51	39° 14' 55.69"	009° 03' 46.63"
124	39° 15' 24.00"	009° 03' 29.65"	52	39° 14' 56.70"	009° 03' 46.51"
125	39° 15' 24.71"	009° 03' 30.72"	53	39° 14' 55.93"	009° 03' 47.12"
14	39° 15' 10.67"	009° 03' 30.16"	55	39° 14' 56.17"	009° 03' 47.62"
15	39° 15' 09.22"	009° 03' 31.49"	57	39° 14' 56.41"	009° 03' 48.12"
16	39° 15' 08.46"	009° 03' 32.47"	60	39° 14' 54.65"	009° 03' 47.61"
20	39° 15' 03.97"	009° 03' 37.55"	61	39° 14' 54.99"	009° 03' 47.10"
21	39° 15' 08.90"	009° 03' 33.79"	62	39° 14' 55.30"	009° 03' 48.31"
22	39° 15' 04.36"	009° 03' 38.86"			
23	39° 15' 05.43"	009° 03' 38.77"			

CHANGE: UPDATED CHART

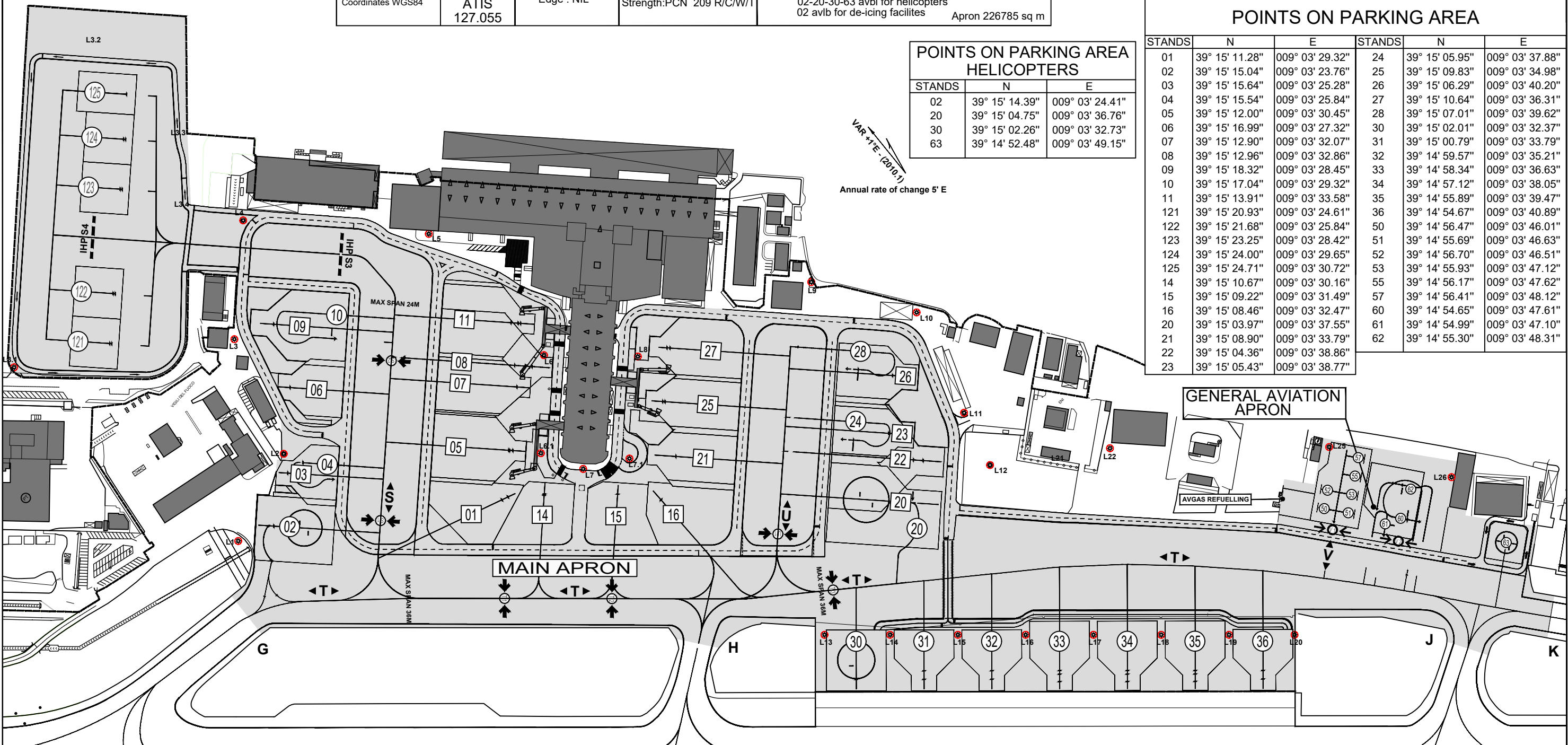

TAXILANE IDENT	RMK	APRON TAXIWAY IDENT	RMK	TAXILANE IDENT	RMK
S	From Apron Taxiway T to stands: 01,02,03,04,05,06,07,08,09,10,11, 121, 122, 123, 124, 125	T	1: From TWY "G" to intersection Taxilane "S" (included) max wing span restricted to code "D" 2: From intersection Taxilane "S" (excluded) to beginning of TWY "K" Max wing span restricted to Code "C"	U	From Apron Taxiway T to stands: 20,21,22,23,24,25,26,27,28
				V	From Apron Taxiway T to stands: 50 to 57 max wing span 11 m

REMARKS:
1) Visual docking guidance system (Safe Gate) AVBL for stands: 01, 05, 07, 08, 11, 25, 27
2) MAX WING SPAN 24 m for stands: 121, 122, 123, 124, 125
3) MAX WING SPAN 11 m for self manoeuvring stands: 50,51,52,53,55,57
4) MAX WING SPAN 19 m for stands: 60, 62
5) MAX WING SPAN 30.5 m for stands: 61
6) STAND 02: AVBL UP TO S-61 SIKORSKY HELICOPTER
7) STAND 20: AVBL UP TO S-65 SIKORSKY HELICOPTER
8) STAND 30: AVBL UP TO EH 101 AGUSTAWESTLAND HELICOPTER
9) STAND 63: AVBL UP TO EC145 AIRBUS HELICOPTER

LEGEND

- SELF MANOEUVRING
- PUSH BACK
- APRON
- BUILDING
- START ENGINE POINT
- INTERMEDIATE HOLDING POSITION
- LIGHTING TOWER (LX)

Bearings are magnetic
 Distances in metres
 Elevations in feet AMSL
 Coordinates WGS84

TWR	120.605 122.100
GND	125.430
ATIS	127.055

VAR +1°E (2010.1)
 Annual rate of change 5' E

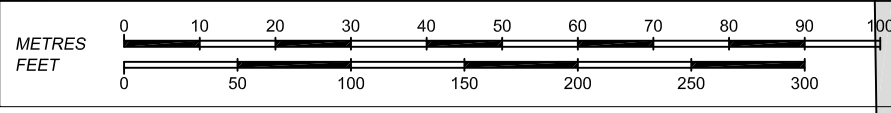

AD ELEV	APRON ELEV	LIEE	CAGLIARI / ELMAS
11	13		39° 14' 50" N 009° 03' 22" E

CHANGE: NEW CHART

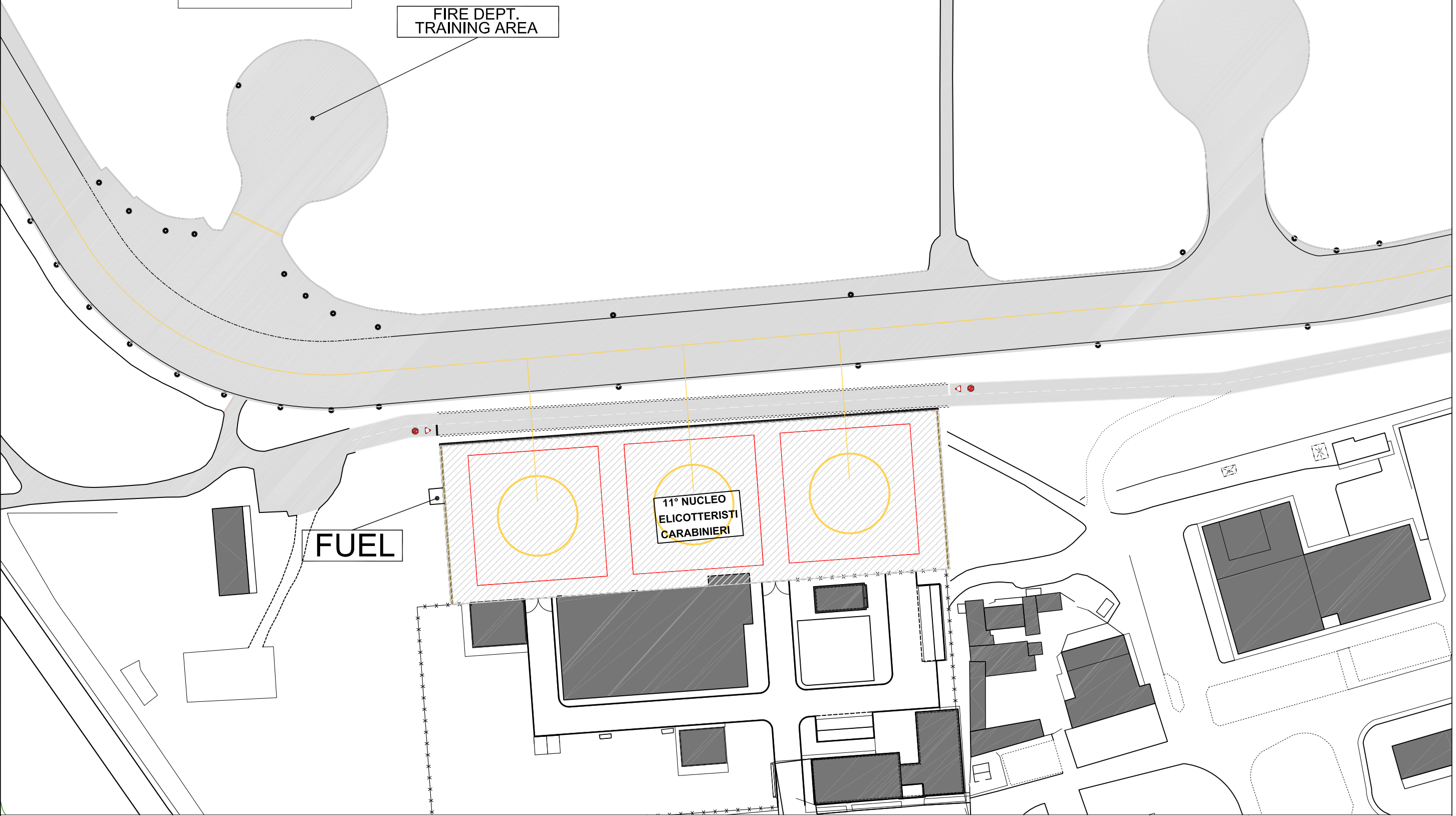

LEGEND

	APRON
	BUILDING

Bearings are magnetic
Distances in metres
Elevations in feet AMSL
Coordinates WGS84

TWR
120.605 122.100
GND
125.430
ATIS
127.055

VAR +1°E (2010.1)
Annual rate of change 5" E

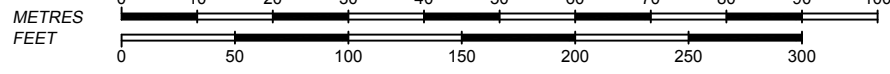

AD ELEV
11

APRON ELEV
13

LIEE

CAGLIARI / ELMAS

39° 14' 50" N 009° 03' 22" E

GENERAL AVIATION APRON

MILITARY APRON

21° GRUPPO SQUADRONI
AVIAZIONE DELL'ESERCITO
"ORSA MAGGIORE"

CHANGE: LAYOUT UPDATED

J

K



LEGEND

- APRON
- BUILDING